

Active Suspension for TAMIYA 1/16 JGSDF Type10 Installation Manual

1 Suspension mount

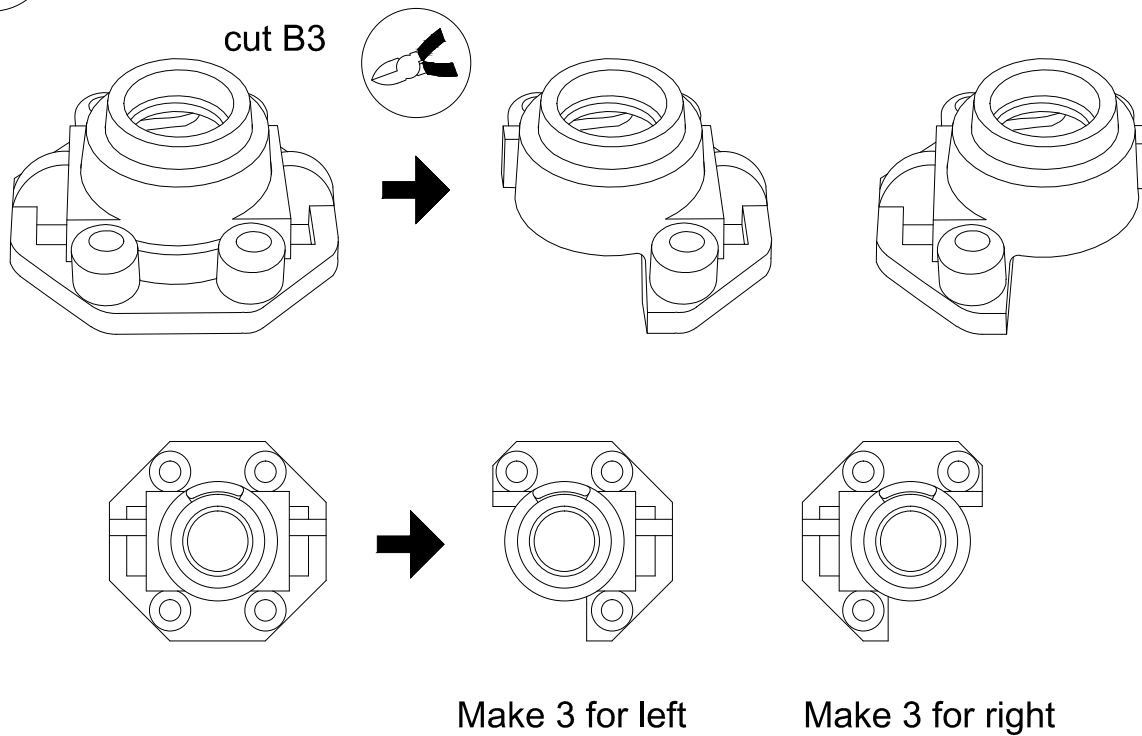

2 Suspension spring

cut suspension springs

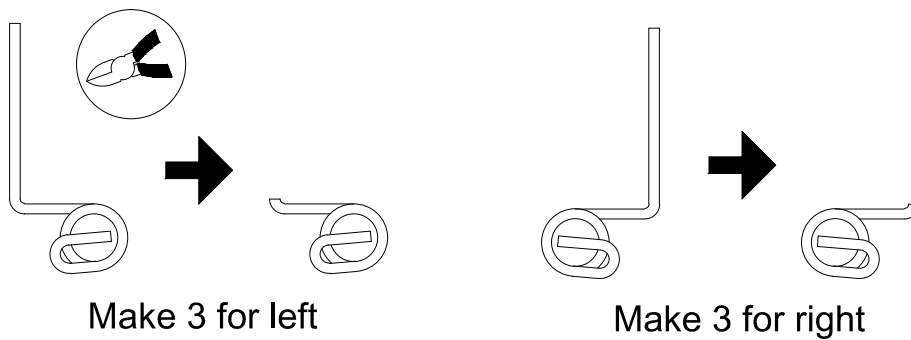

3 Installation of suspension mounts

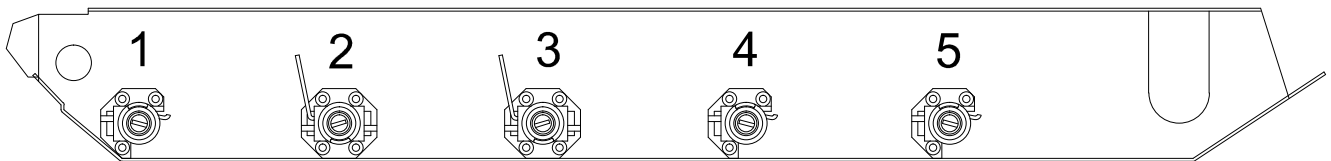
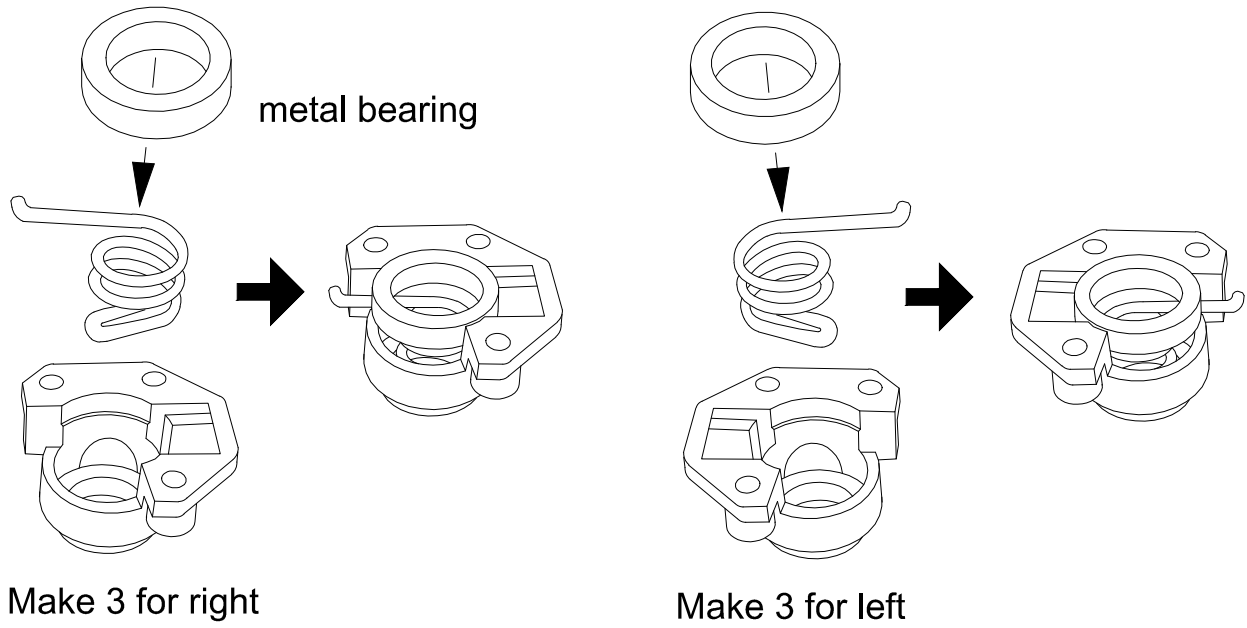

Wheels 1,4,5

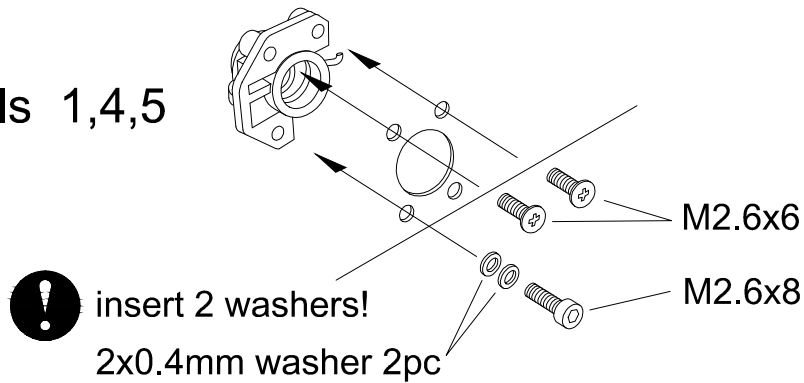

Wheels 2,3

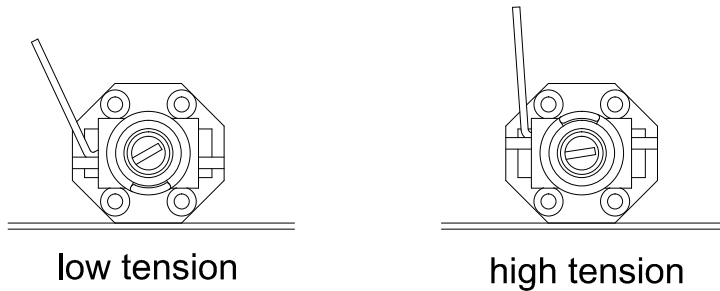

for wheels 2,3, you can select high or low tension according to weight of tank, use high tension for heavy body

4 Front suspension

Step 1  remove screw cap K1 insert suspension arm and bearing



insert B15 insert idler wheel

Step 2 install mounting plate





M2.6x6 secure idler wheel

Step 3 insert front lift gear

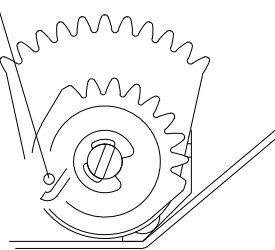

 keep pin on top of suspension spring

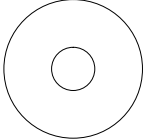

 
5x0.2mm washer E-ring



Step 4 install servo assembly, gears must well aligned!

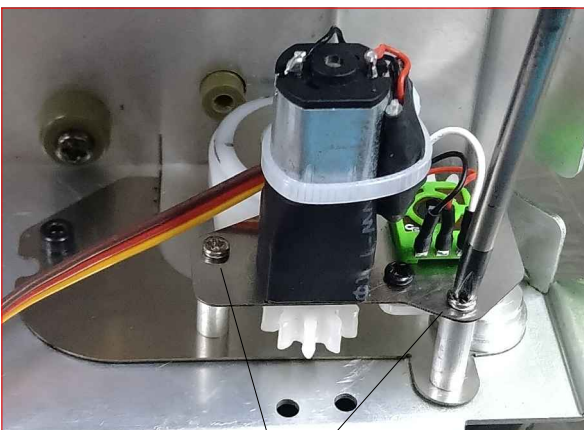

M2x4 screws

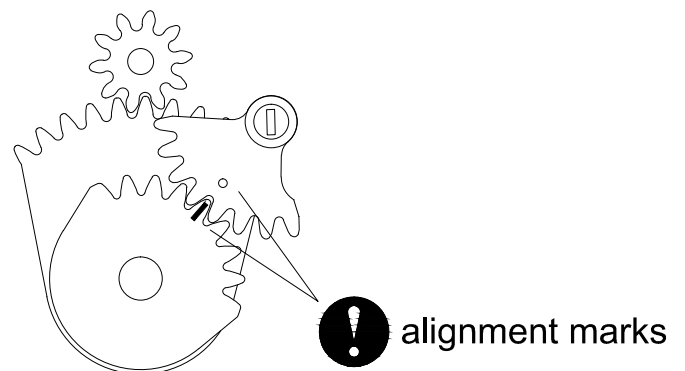

5 Rear suspension

Step 1

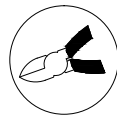

cut C26



secure B16 with PA3x10 screw



Step 2

insert suspension arm and metal bearing of wheel 5



attach C36 with M2.6x6 screw

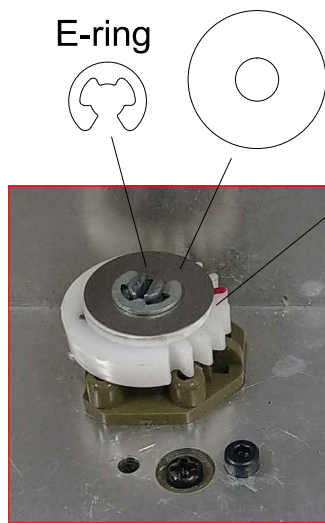

E-ring

5x0.2mm washer

5x1.5mm washer



keep pin on top of suspension spring

Step 3

install servo assembly, gears must well aligned!

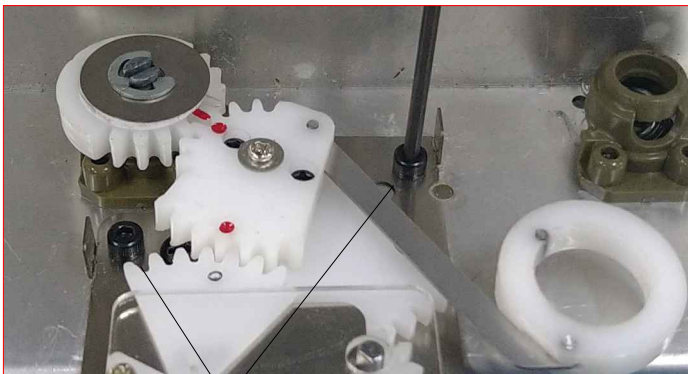

secure M2.6x6 screws

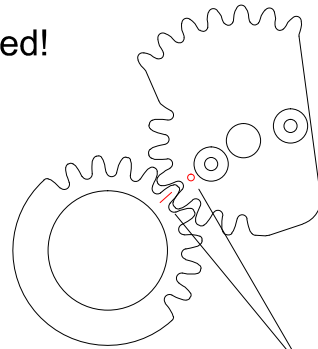

alignment marks

Step 4

insert suspension arm and metal bearing of wheel 4



E-ring

5x0.2mm washer

5x1.5mm washer



keep pin on top of suspension spring

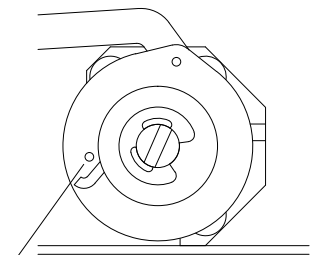

6 Control of servos

The active suspension unit can be controlled by 1, 2 or 4 RC channels:

1) Control by 1 channel:

All servos are combined to use one RC channel. Front and rear suspensions will move in opposite direction. Tank will lean forward or backward.

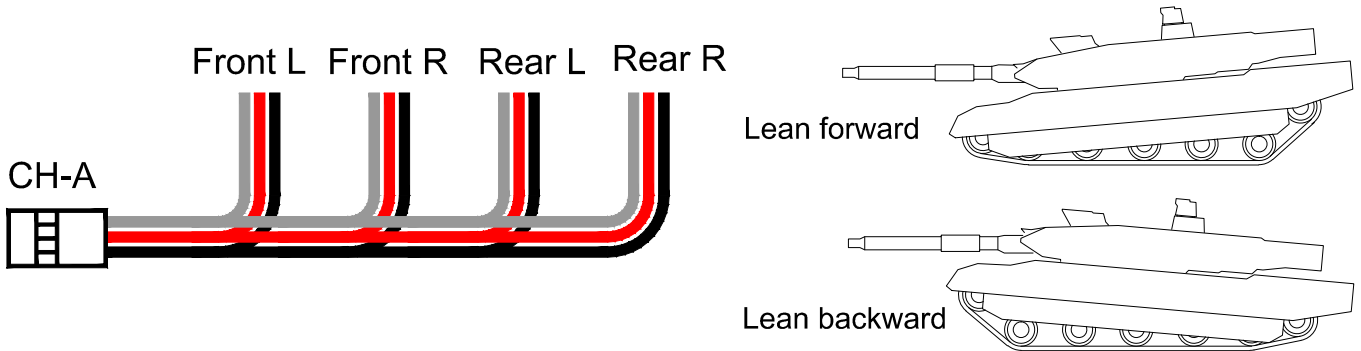

2) Control by 2 channels:

Front and rear servos are controlled by 2 RC channels. Front and rear suspension move independently. Tank will lean forward or backward, ride high or low.

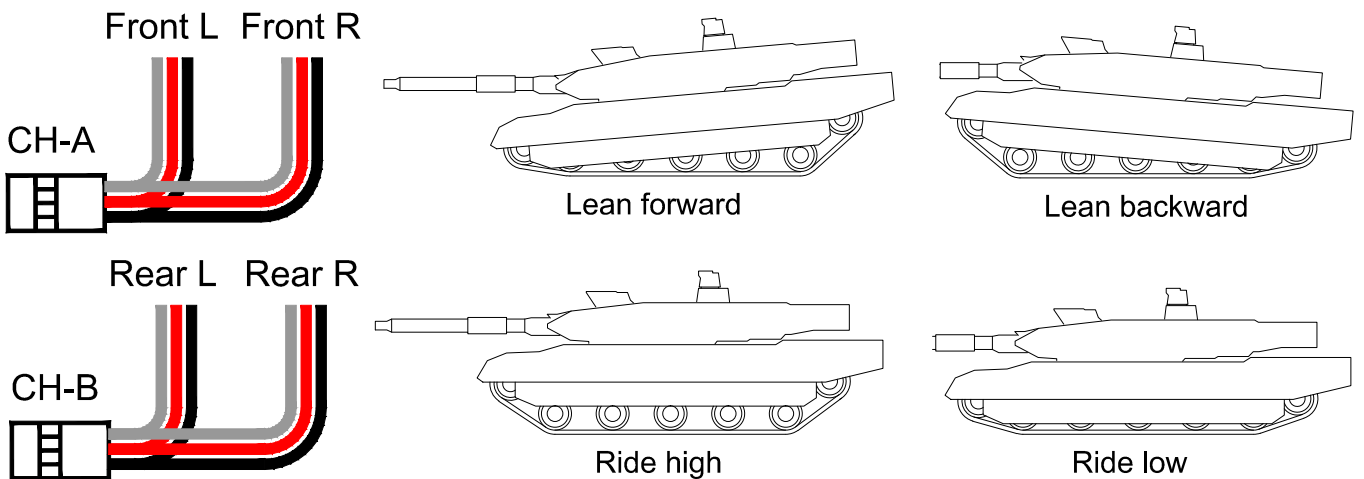

3) Control by 4 channels:

Four servos moves independently. In addition to lean forward or backward, ride high or low, tank can also roll left or right.

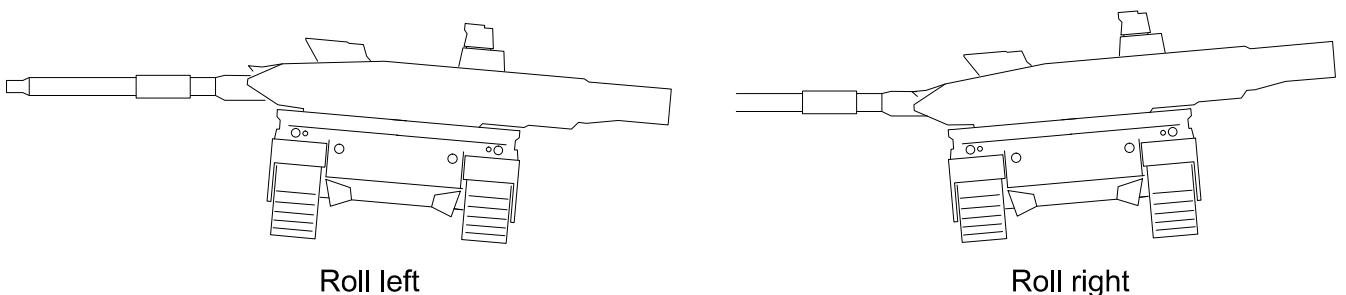

7 Power supply

The active suspension unit require 5V/1A power supply from the receiver. To avoid overloading of RC tank controller, it is recommend to use an external UBEC to provide receiver power. When using external UBEC, it is require to remove all +5V supplies from RC tank controller.

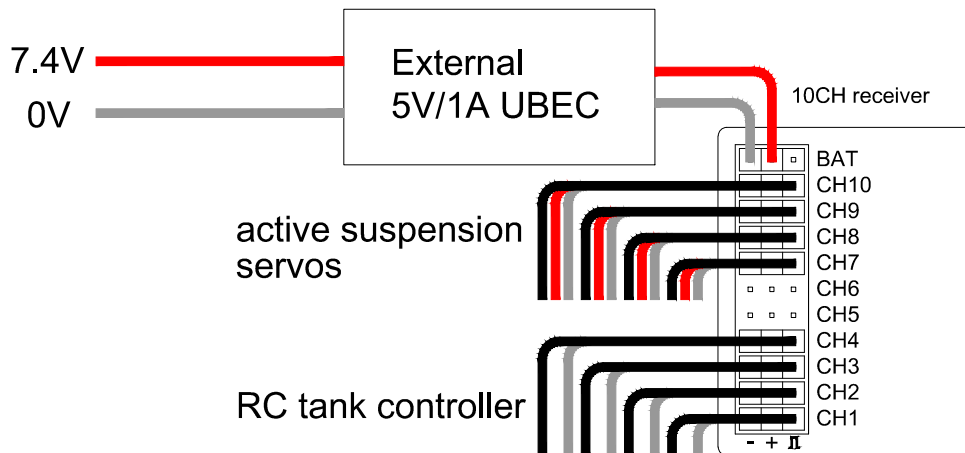

! remove all +5V supplies from RC tank controller!

8 Installation in Tamiya RC version

- 1) Remove 18mm at both side from double differential gearbox

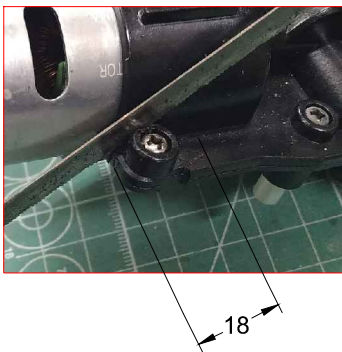

- 2) The front active suspensions will take up space for the speaker. Please move speaker backward, or cut speaker case to made room for it.
- 3) As the receiver is located inside the turret, you have to extend the servo cables.