

# RC Conversion Kit for Tamiya 1/16 Leopard A4 (Item 36207) LED Gun Version (2025 Edition)

Note: This kit is designed for TAMIYA Item 36207 and may not be suitable for early Leopard1A4 versions

## Attention!

- 1) This kit is designed for experienced model makers. It may be difficult for beginners. Please read this manual thoroughly to see if you have the required skills and tools.
- 2) Cutting tools are used frequently in this kit. Extra care should be taken to avoid injury. Wear hand gloves and eye protection spectacle if necessary.
- 3) Keep room well ventilated when working with cements, paints and organic solvents.
- 4) Visit [www.35rctank.com](http://www.35rctank.com) for additional tips and update information.

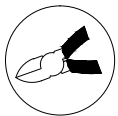

side cutter



apply cement

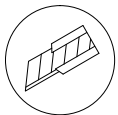

modelling knife



do not apply cement

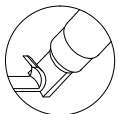

carving knife

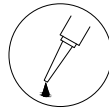

apply instant glue



all purpose glue



solder

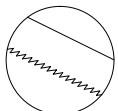

hand saw

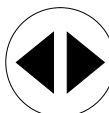

both sides



Attention!

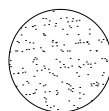

polish with sand paper

# 1 Gearbox and sprocket

install gearbox as shown

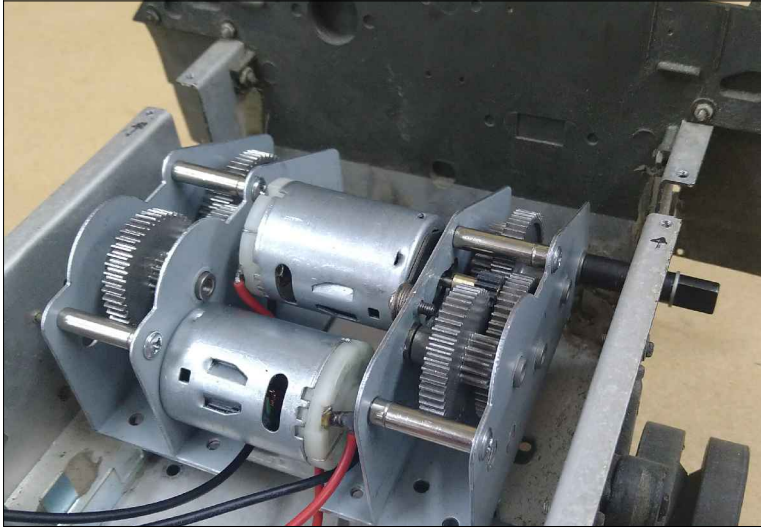

secure gearbox with M3x5 screws

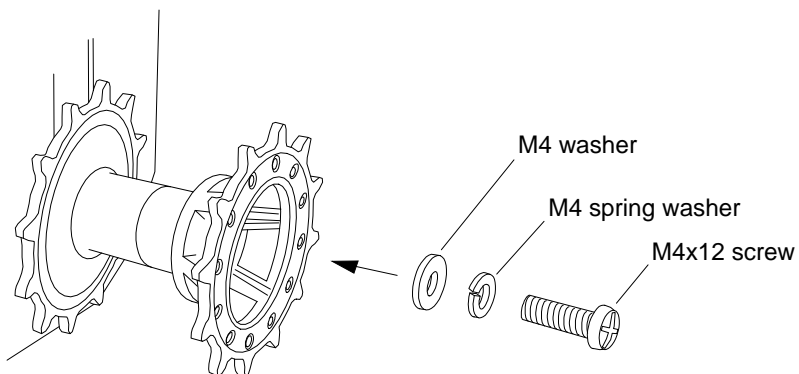
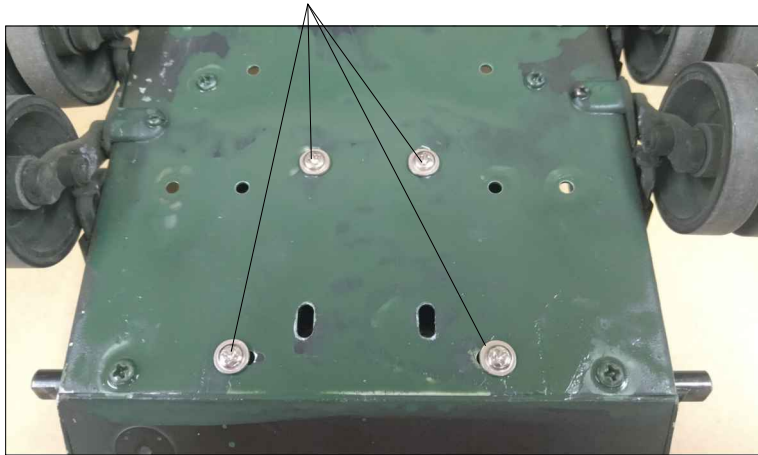

secure sprocket with M4x12 screw

# 2 Turret

remove turret locking plates

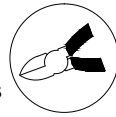

remove

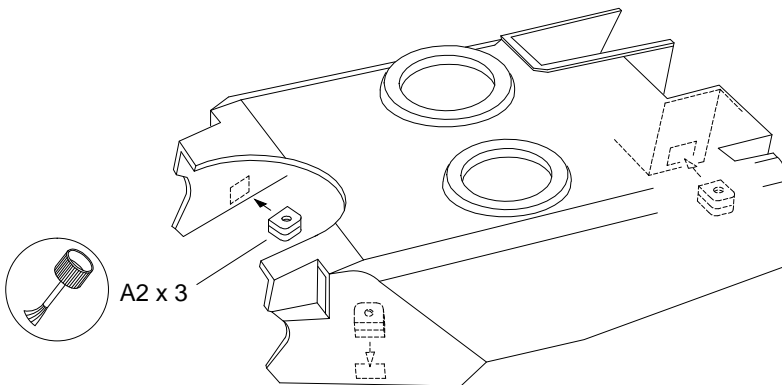
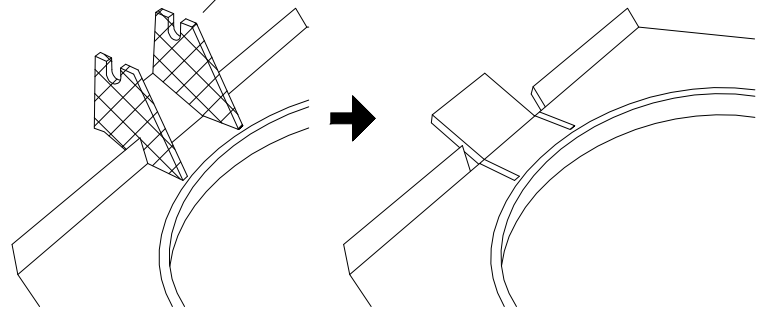
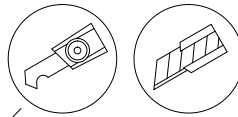

A2 x 3

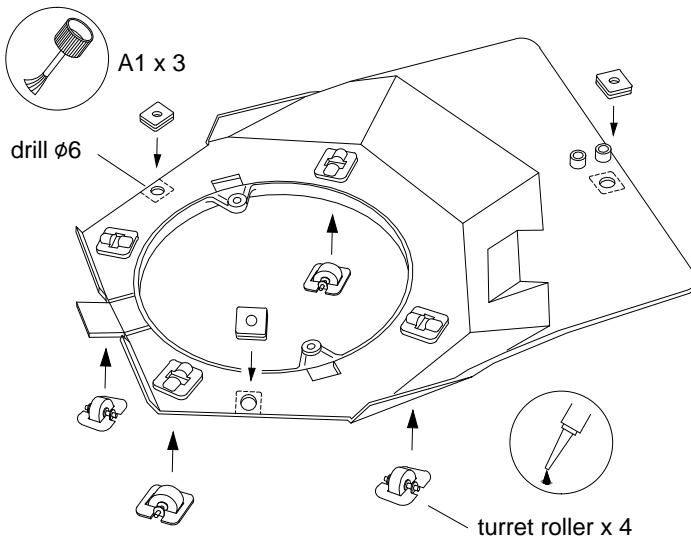
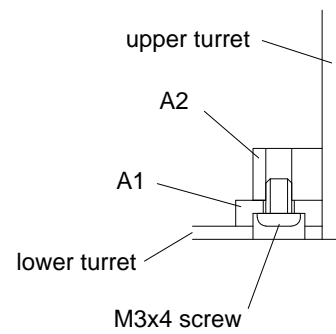

A1 x 3

drill ø6

turret roller x 4

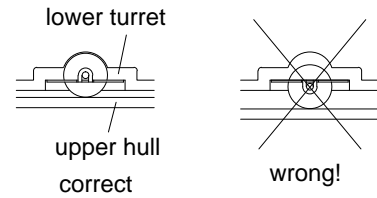

lower turret

upper hull  
correct

wrong!

**!** Notice correct orientation!  
Attach with little instant glue.  
Take care not to stick moving parts!



**!** insert adaptor ring



### 3 Gun barrel

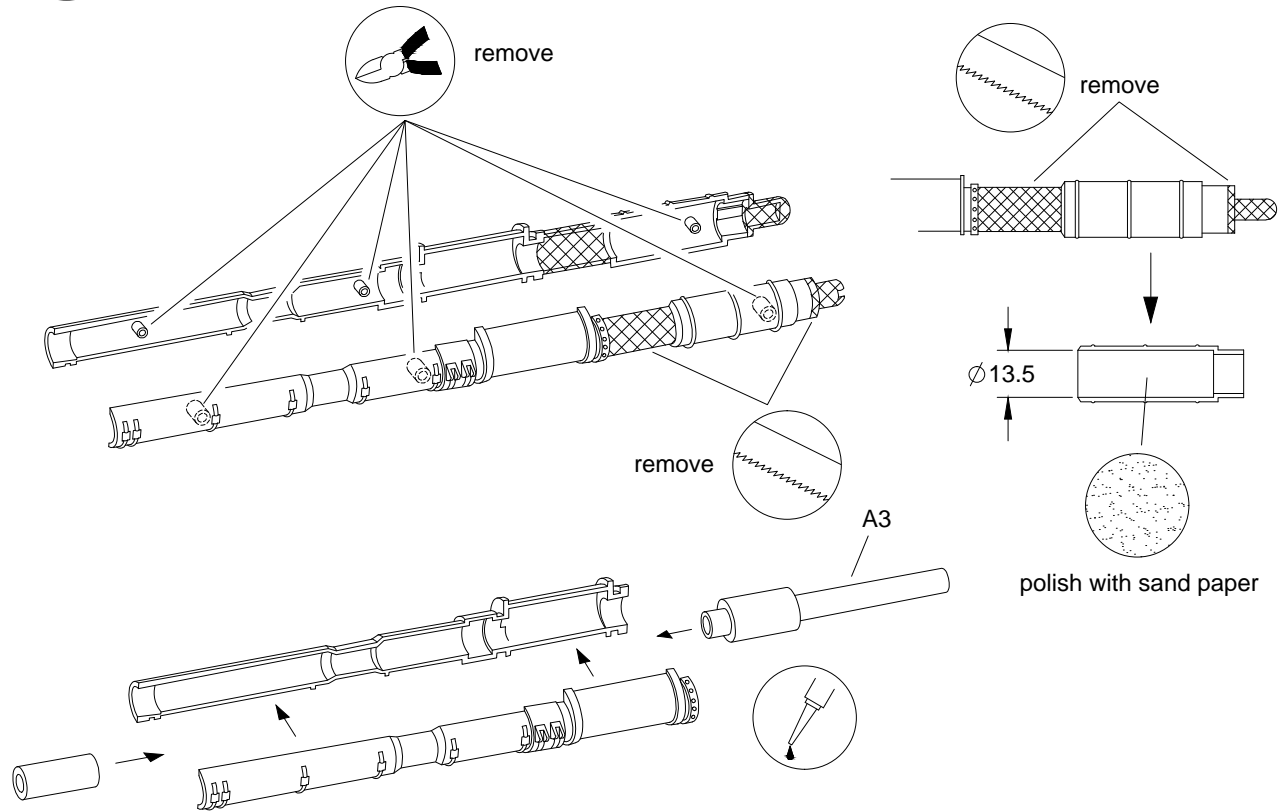

### 4 Turret and gun servo assembly

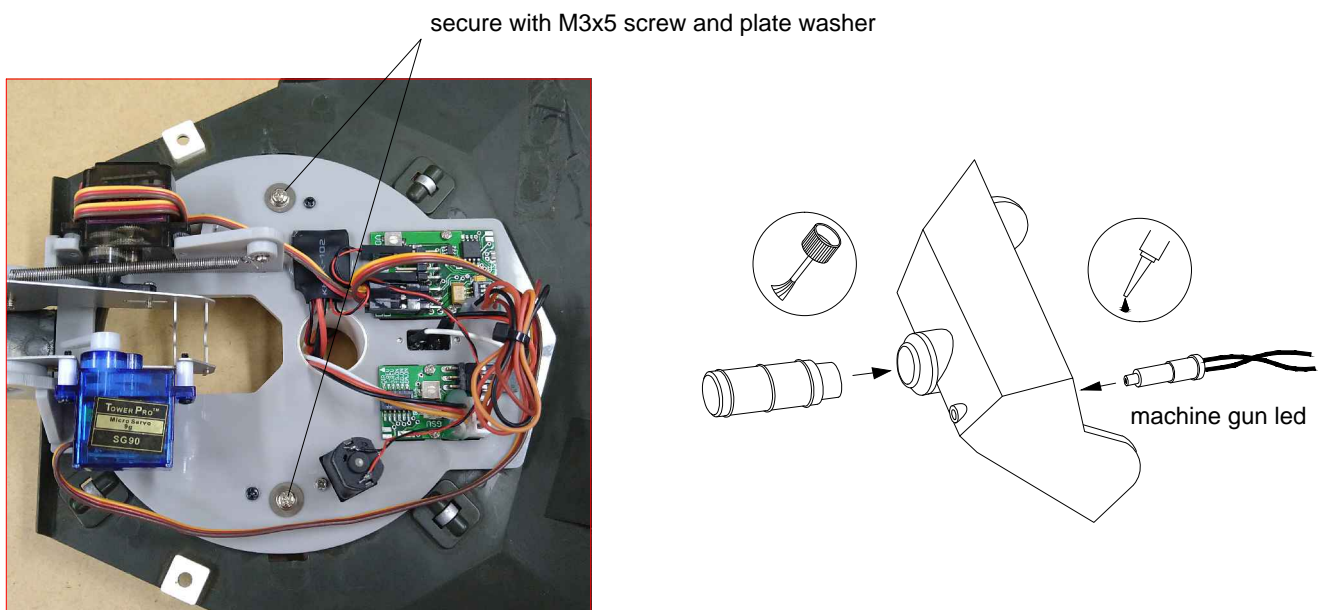

# 5 Attach gun barrel

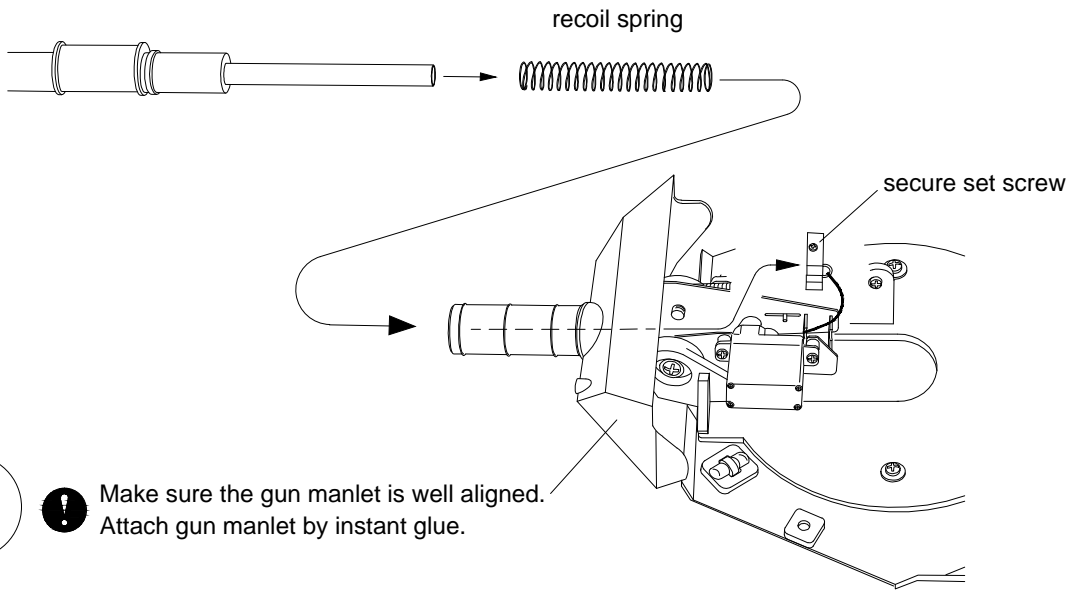

! Make sure the gun manlet is well aligned.  
Attach gun manlet by instant glue.

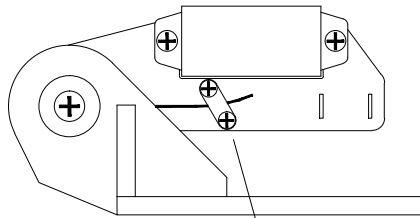

! adjust recoil travel if necessary

# 6 Gun flash LED

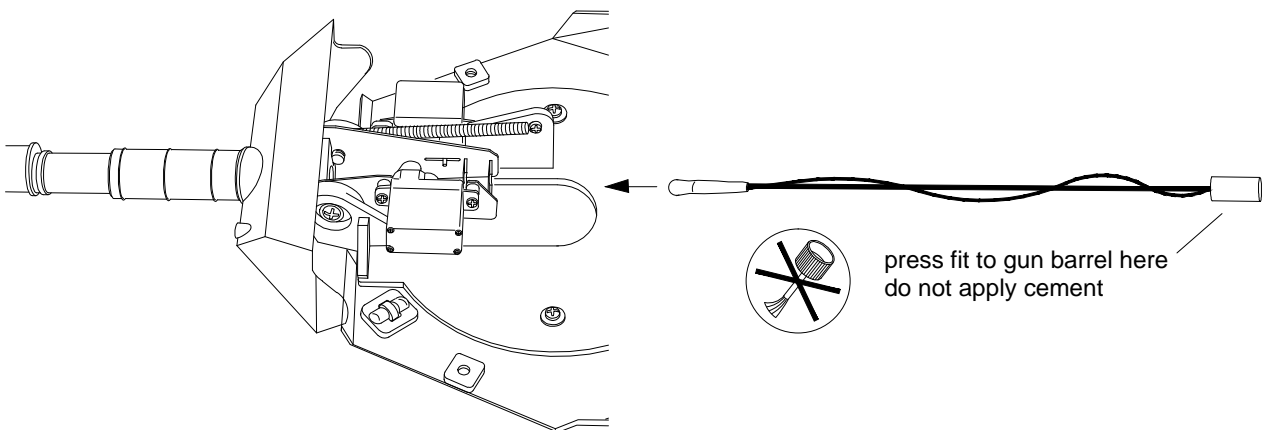

# 7 Turret ring gear and track covers

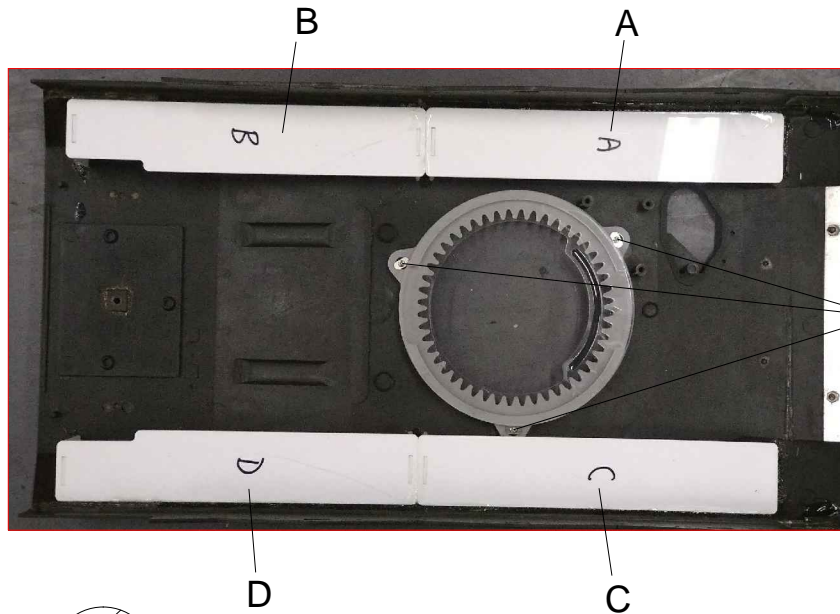

secure ring gear with M2x5 screws and plate washers

⚠ Notice correct orientation!

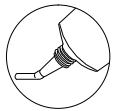

attach track covers A,B,C,D with all purpose glue

# 8 LED head lights



1) use aluminum sticker to make reflector



2) drill  $\phi 1.2\text{mm}$  hole



3) insert LED head light



4) drill  $\phi 1.2\text{mm}$  hole on upper hull

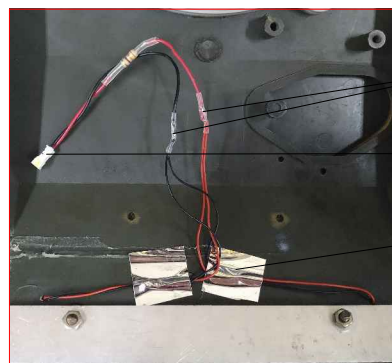

wrap with heat shrink tubings

LED power connector

secure cables with adhesive tapes

5) attach head lights and connect to power connectors

## 9 Attach turret

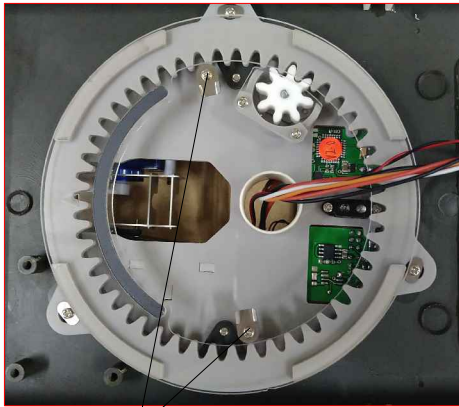

1) rotate locking plate inward,  
attach turret to lower hull



2) rotate and secure locking plate

## 10 Lower hull connections

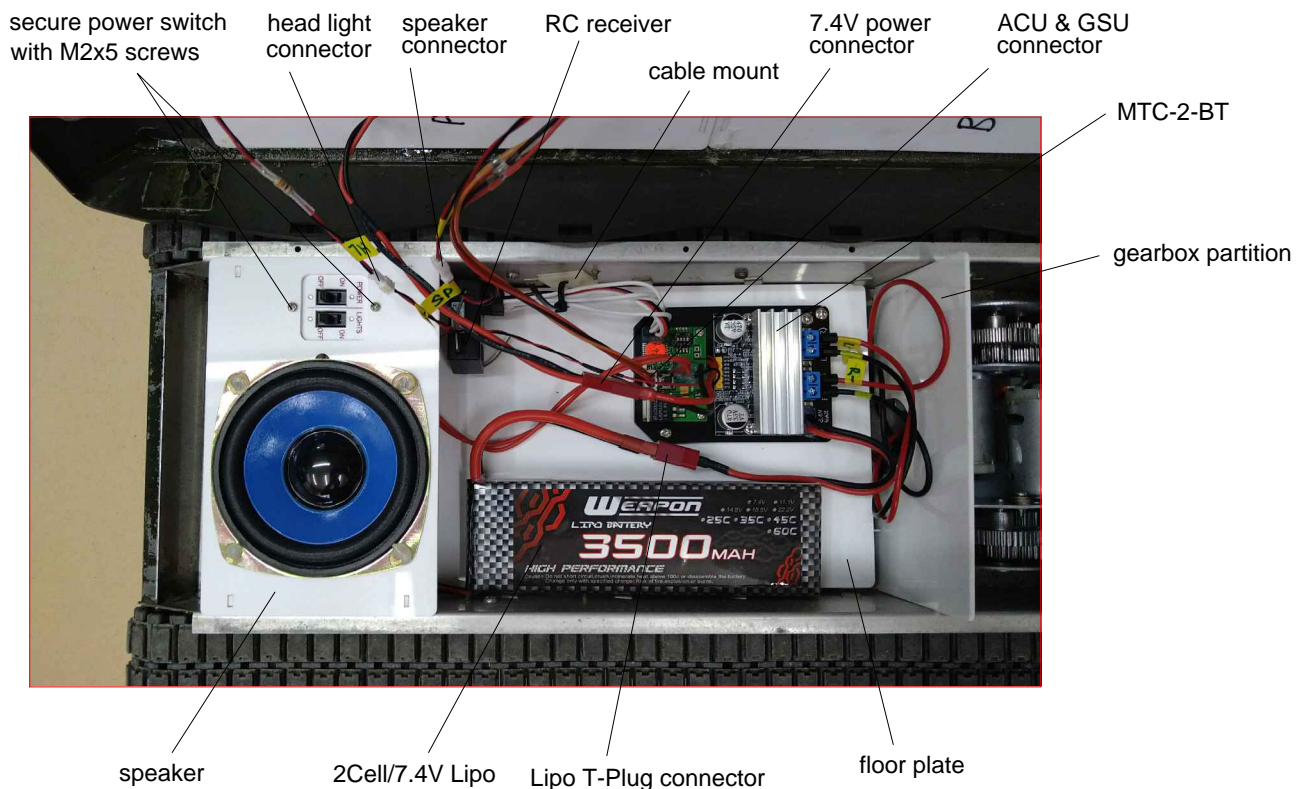

Use T-Plug 2 Cell (7.4V) Lipo

⚠ Lipo battery can be dangerous if not use properly!

Follow all safety precautions and always use a dedicated Lipo charger.