

# RC Conversion Kit for Tamiya (Asuka) 1/35 Sherman Firefly

with MTC-2 and ACU

## User Manual

### Attention!

- 1) This kit is designed for experienced model makers. It may be difficult for beginners. Please read this manual thoroughly to see if you have the required skills and tools.
- 2) Cutting tools are used frequently in this kit. Extra care should be taken to avoid injury. Wear hand gloves and eye protection spectacle if necessary.
- 3) Keep room well ventilated when working with cements, paints and organic solvents.
- 4) Visit [www.35rctank.com](http://www.35rctank.com) for addition tips and update information.

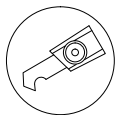

scriber



apply cement

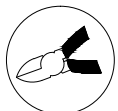

side cutter



do not apply cement

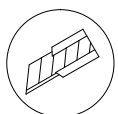

modelling knife

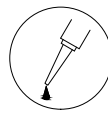

apply instant glue

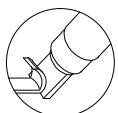

carving knife



wait overnight

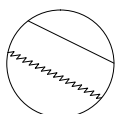

hand saw



solder



Attention!

# 1 VVSS spring plate

! Apply glue carefully! Avoid sticking moving parts!

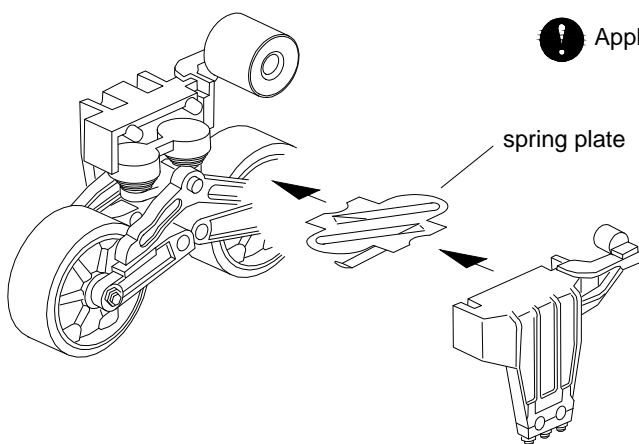

# 2 Gearbox

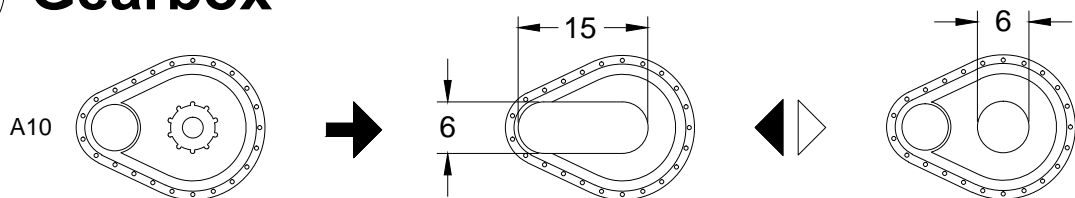

Option 1: gearbox is removable

Option 2: gearbox is not removable

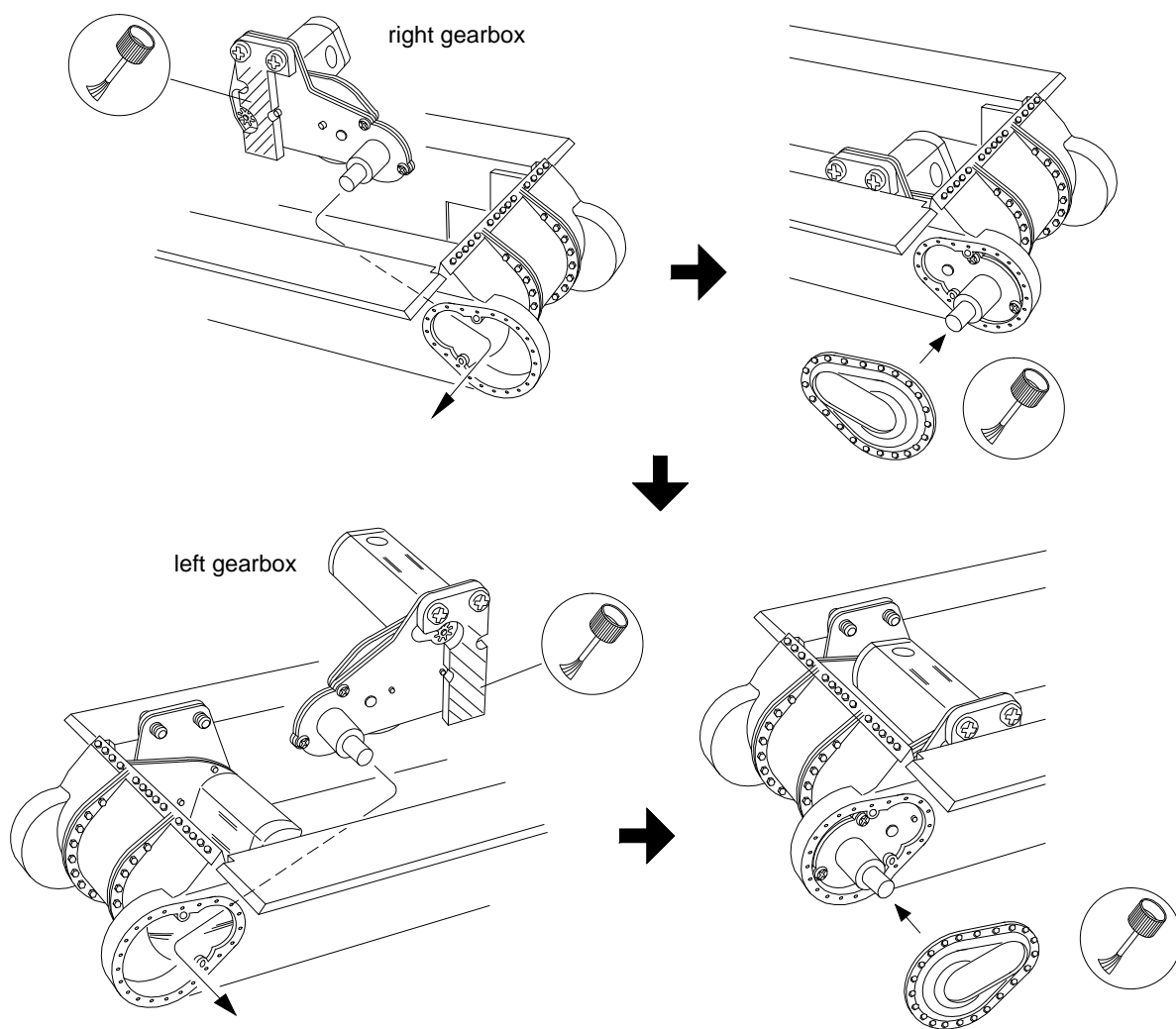

### 3 MTC-2 mount and snap catch

! MTC-2 mount must locate at left side

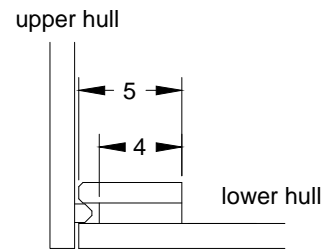
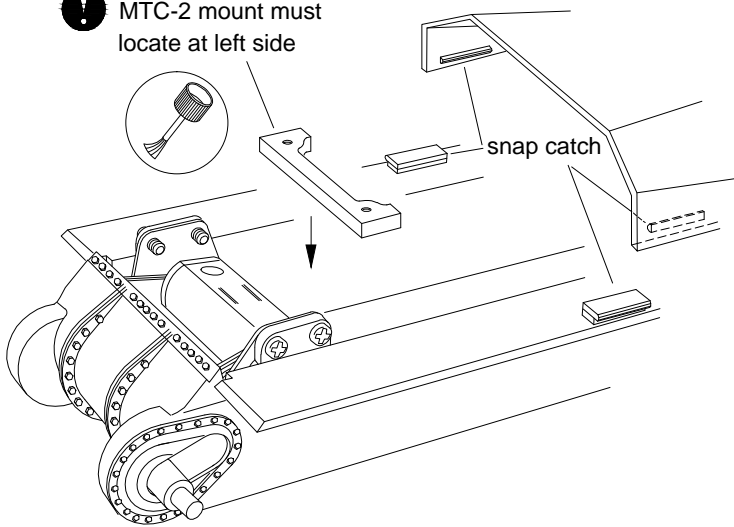

! Use 1mm PS plate to make two snap catch

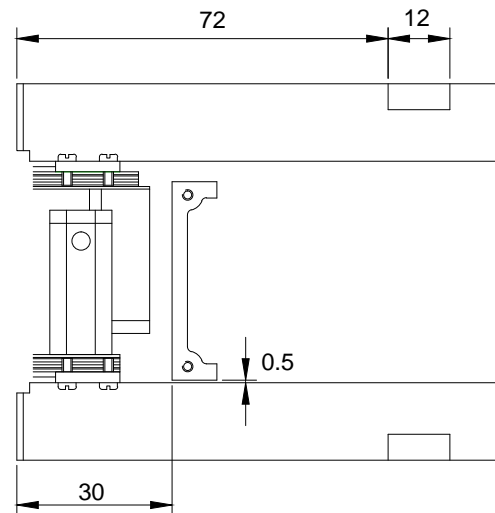

### 4 Sprocket

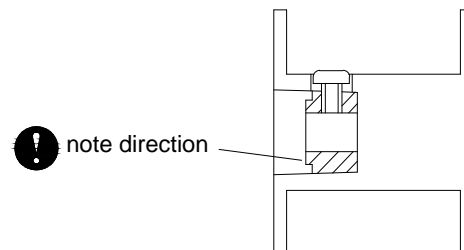
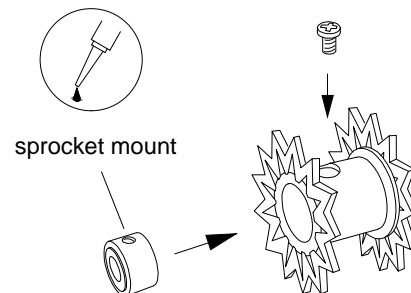
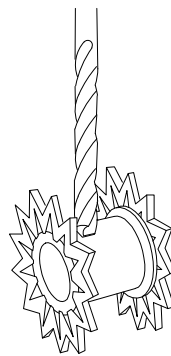
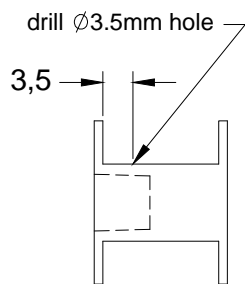

## 5 Turret

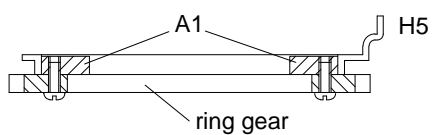
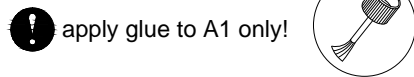
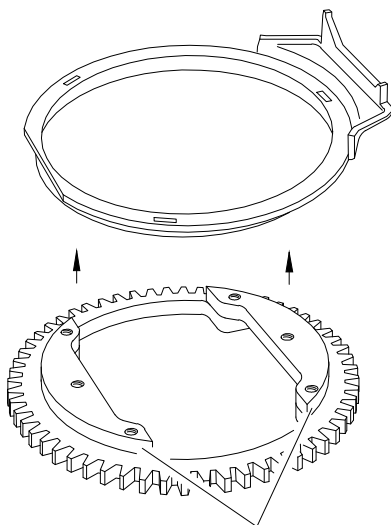
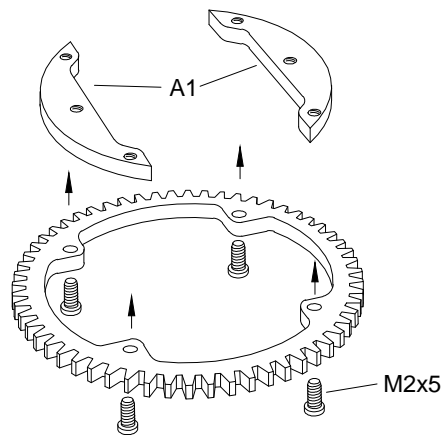
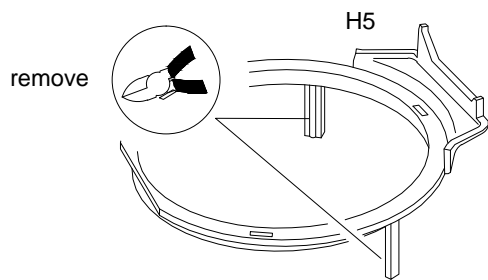

remove ring gear after glue is secured

## 6 Main gun

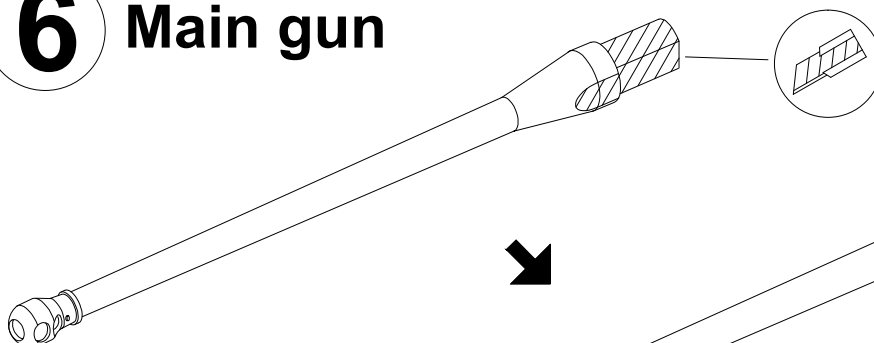

Drill  $\varnothing 3 \times 6\text{mm}$  deep

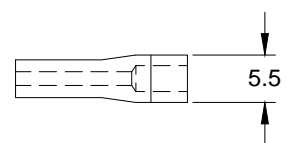

Drill  $\varnothing 2 \times 25\text{mm}$  deep

## 6 Main gun

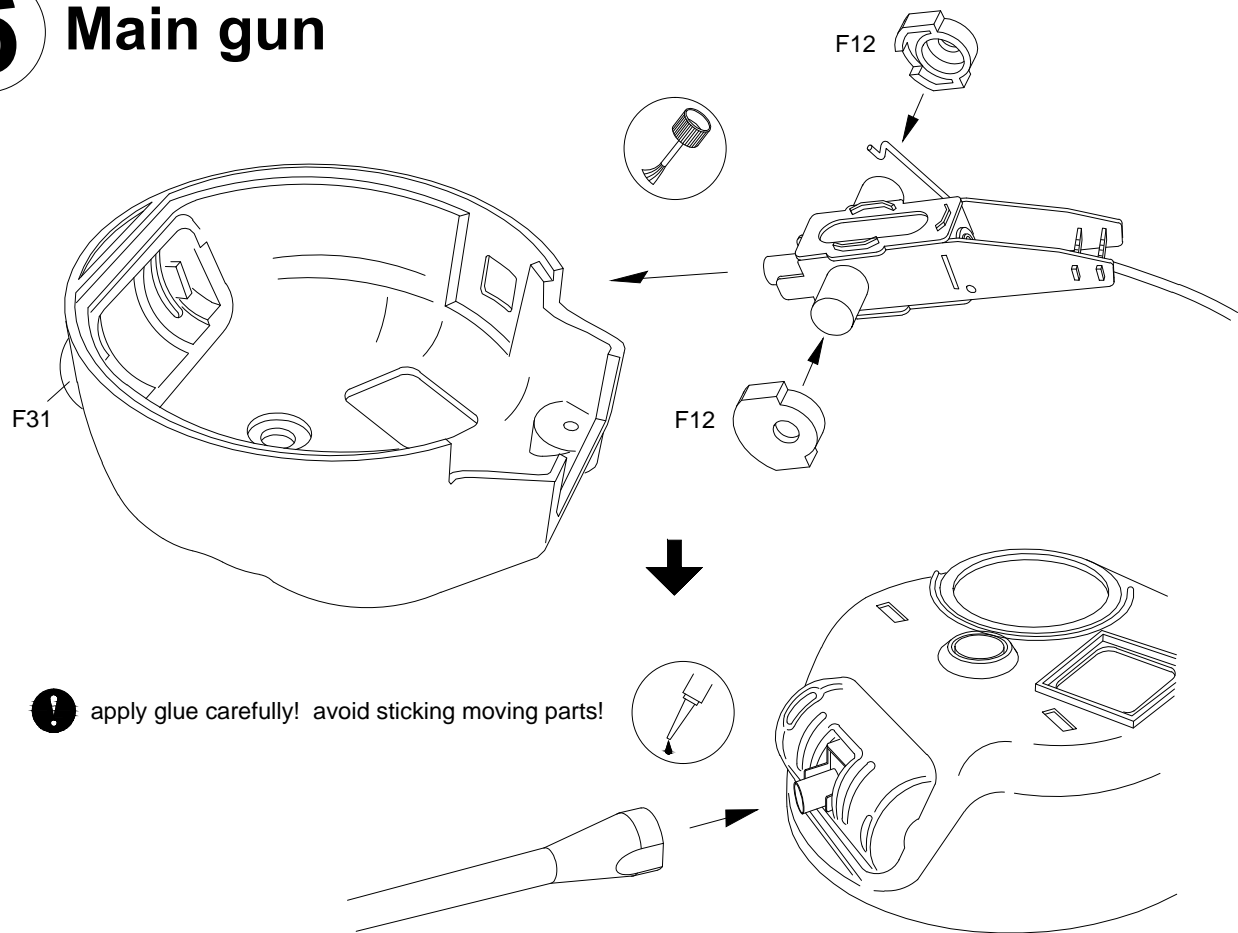

## 7 Main gun and machine gun LEDs

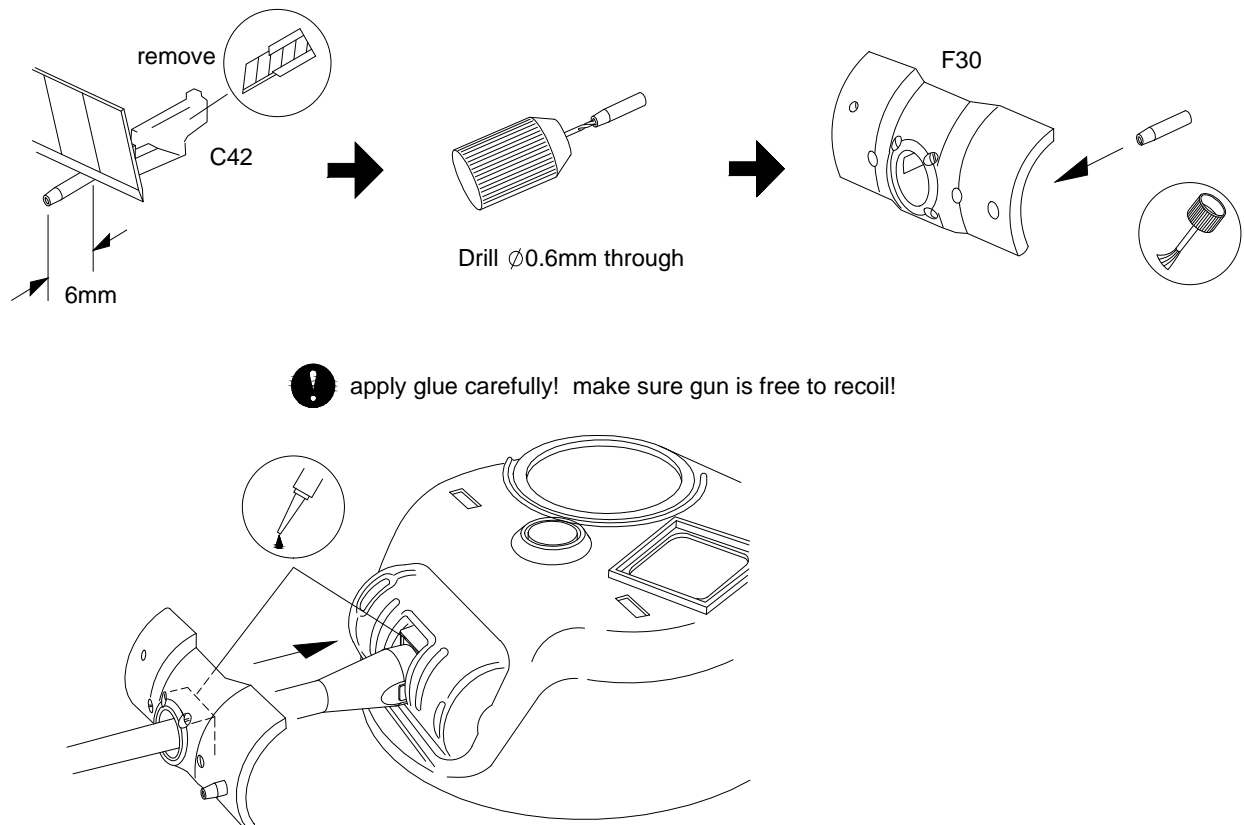

## 7 Main gun and machine gun LEDs

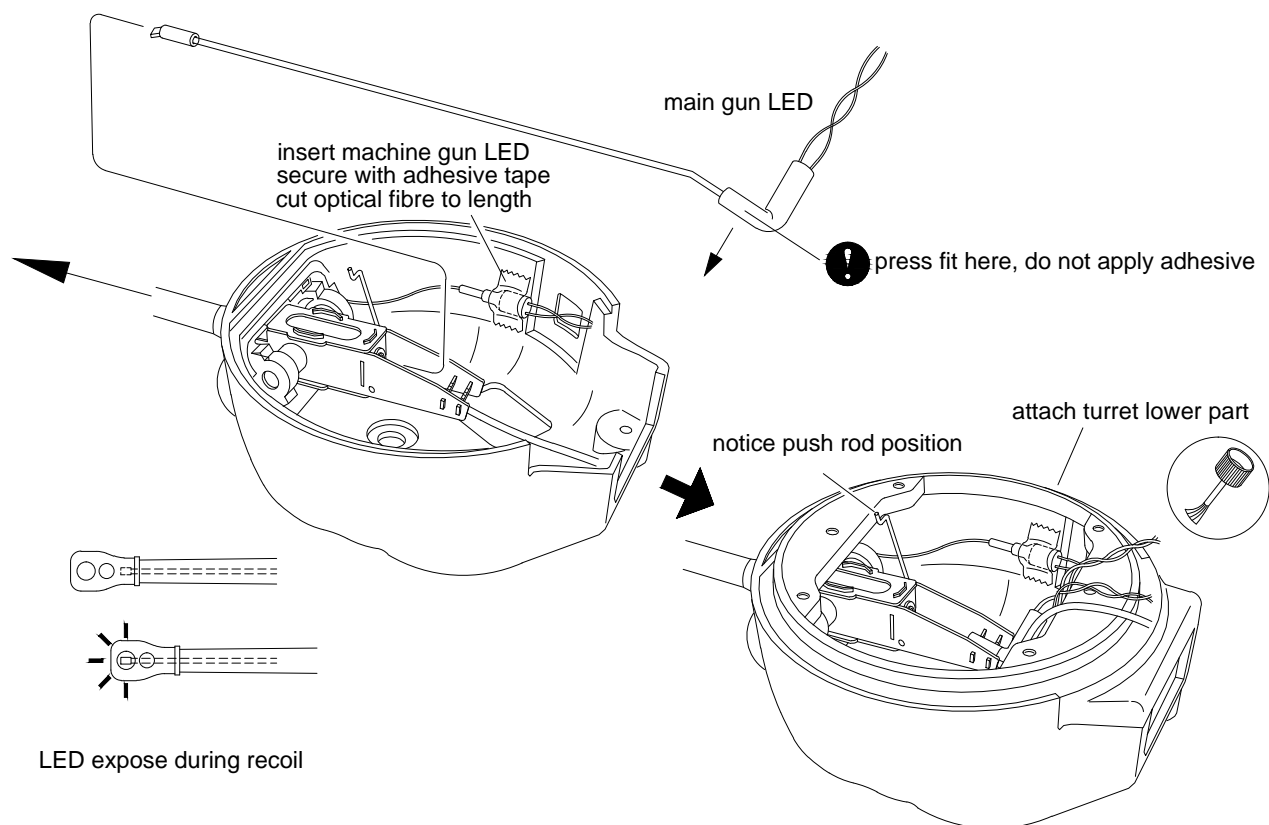

## 8 Gun elevation and recoil servos

Step1) attach recoil servo

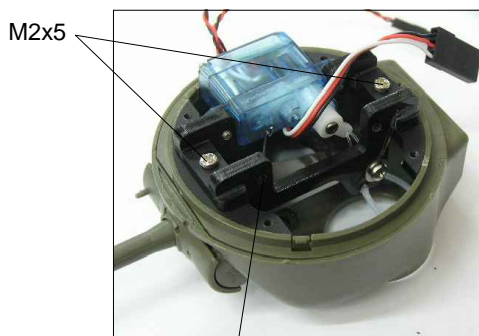

remove gun elevation servo



notice telfon tube orientation

Step2) remove recoil servo temporary, pass LED cables under recoil servo



pass LED cables  
under recoil servo

Step3) secure recoil servo again



## 8 Gun elevation and recoil servos

Step4) install gun elevation servo

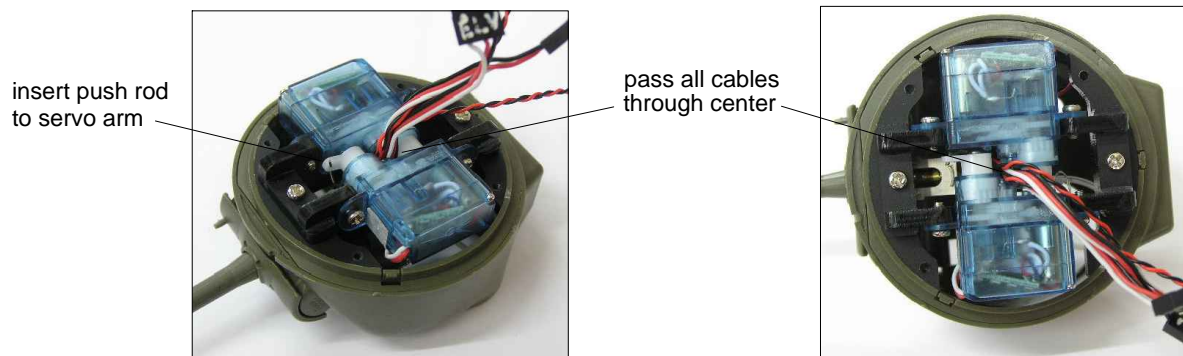

## 9 Attach turret

Step1) position turret to upper hull



Step2) secure ring gear with M2x5 screws

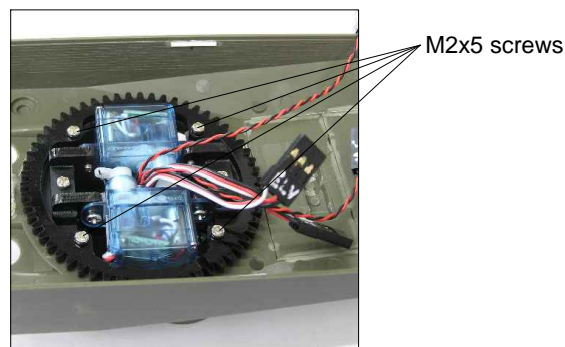

## 10 Turret rotation servo and speaker

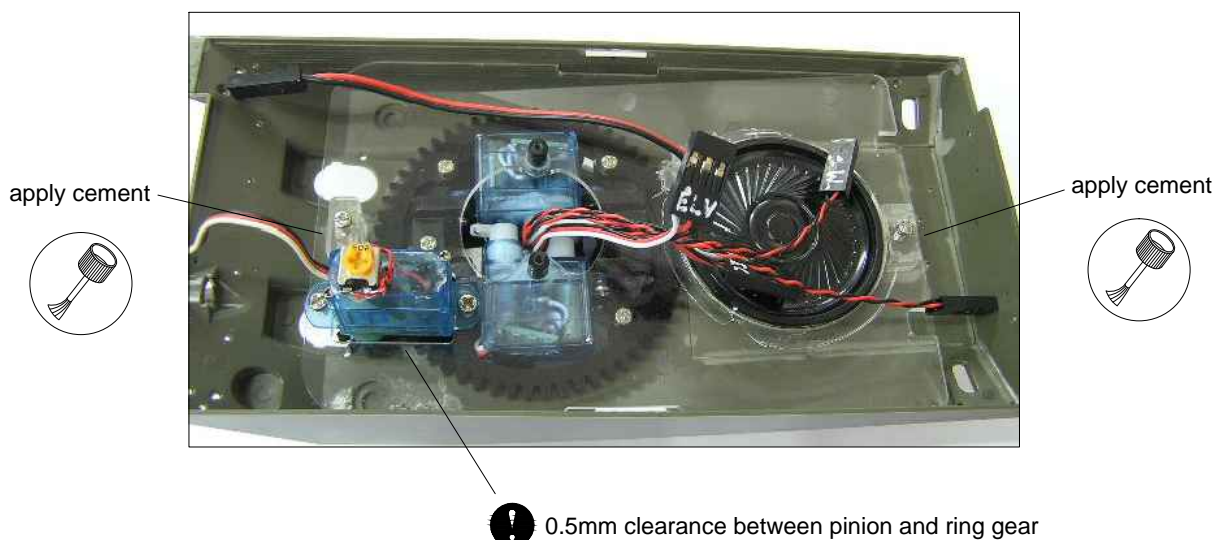



## 11 Install ACU

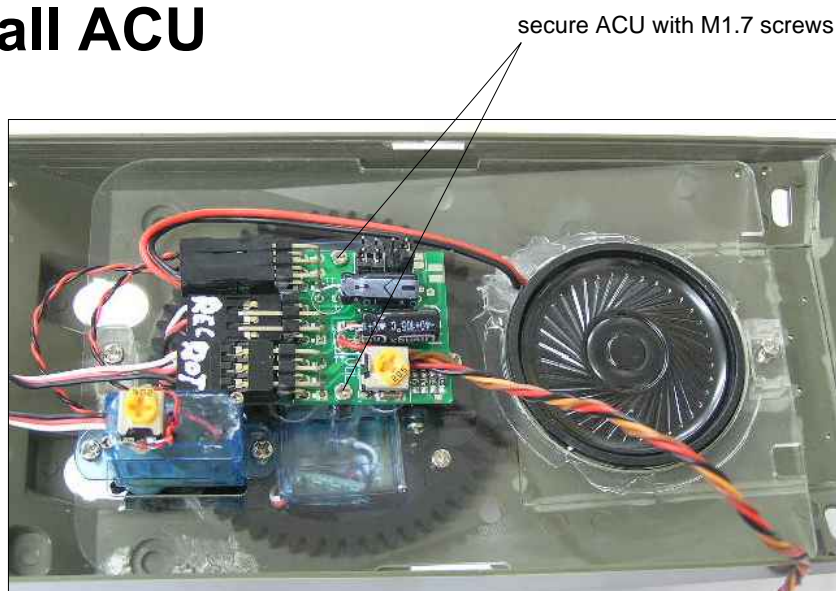

## 12 Lower hull connections

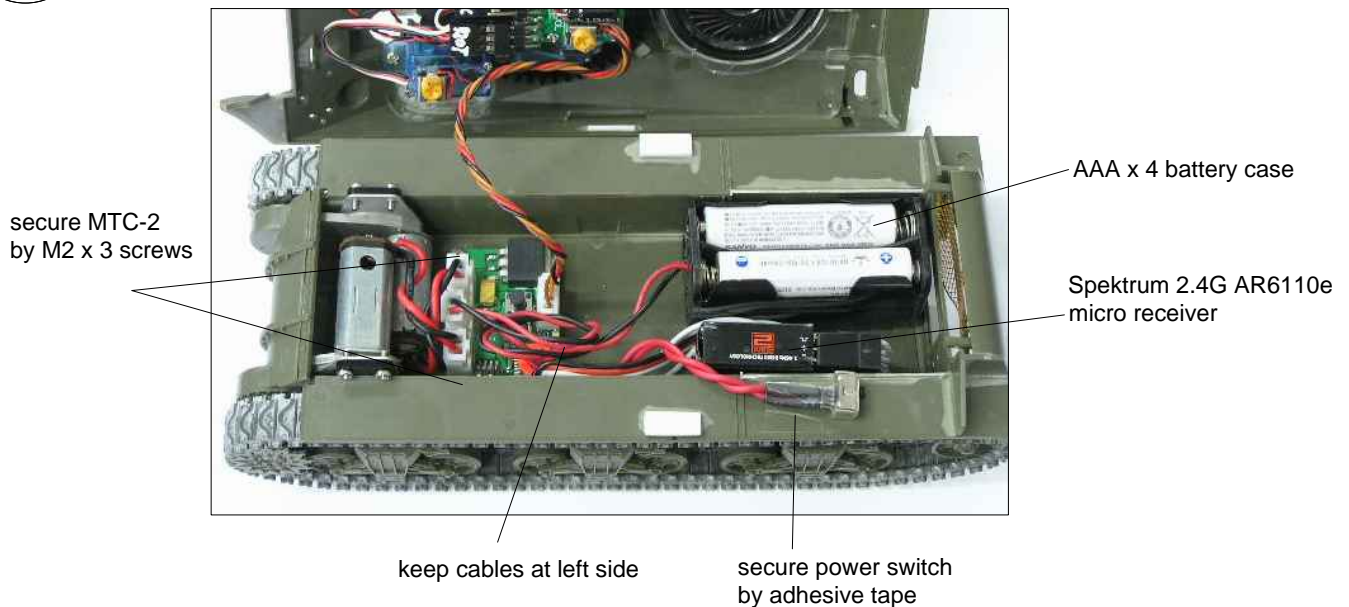

## 13 Apply baby powder to tracks



apply some baby powder to tracks for smoother run