

RC Conversion Kit for Tamiya 1/35 Panther Ausf.D (Item no: 35345)

with MTC-2 and ACU

User Manual

Attention!

- 1) This kit is designed for experienced model makers. It may be difficult for beginners. Please read this manual thoroughly to see if you have the required skills and tools.
- 2) Cutting tools are used frequently in this kit. Extra care should be taken to avoid injury. Wear hand gloves and eye protection spectacle if necessary.
- 3) Keep room well ventilated when working with cements, paints and organic solvents.
- 4) Visit www.35rctank.com for addition tips and update information.

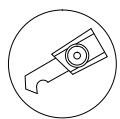

scriber

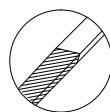

file

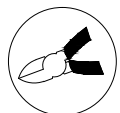

side cutter



apply cement

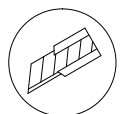

modelling knife



do not apply cement

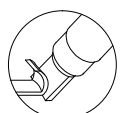

carving knife



apply instant glue

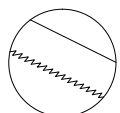

hand saw



wait overnight



paper glue



solder



Attention!

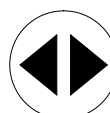

both sides

1 Gearbox

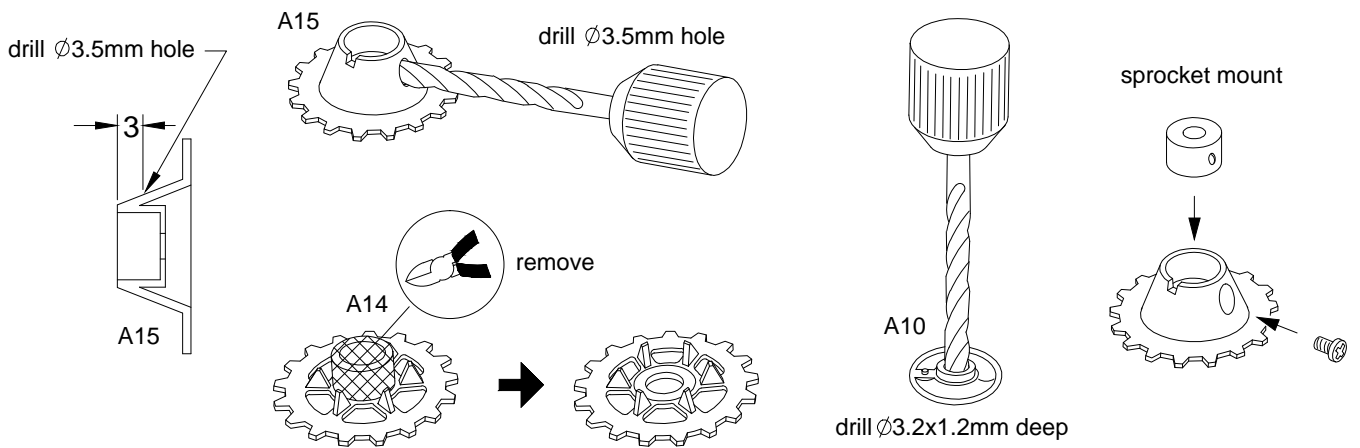
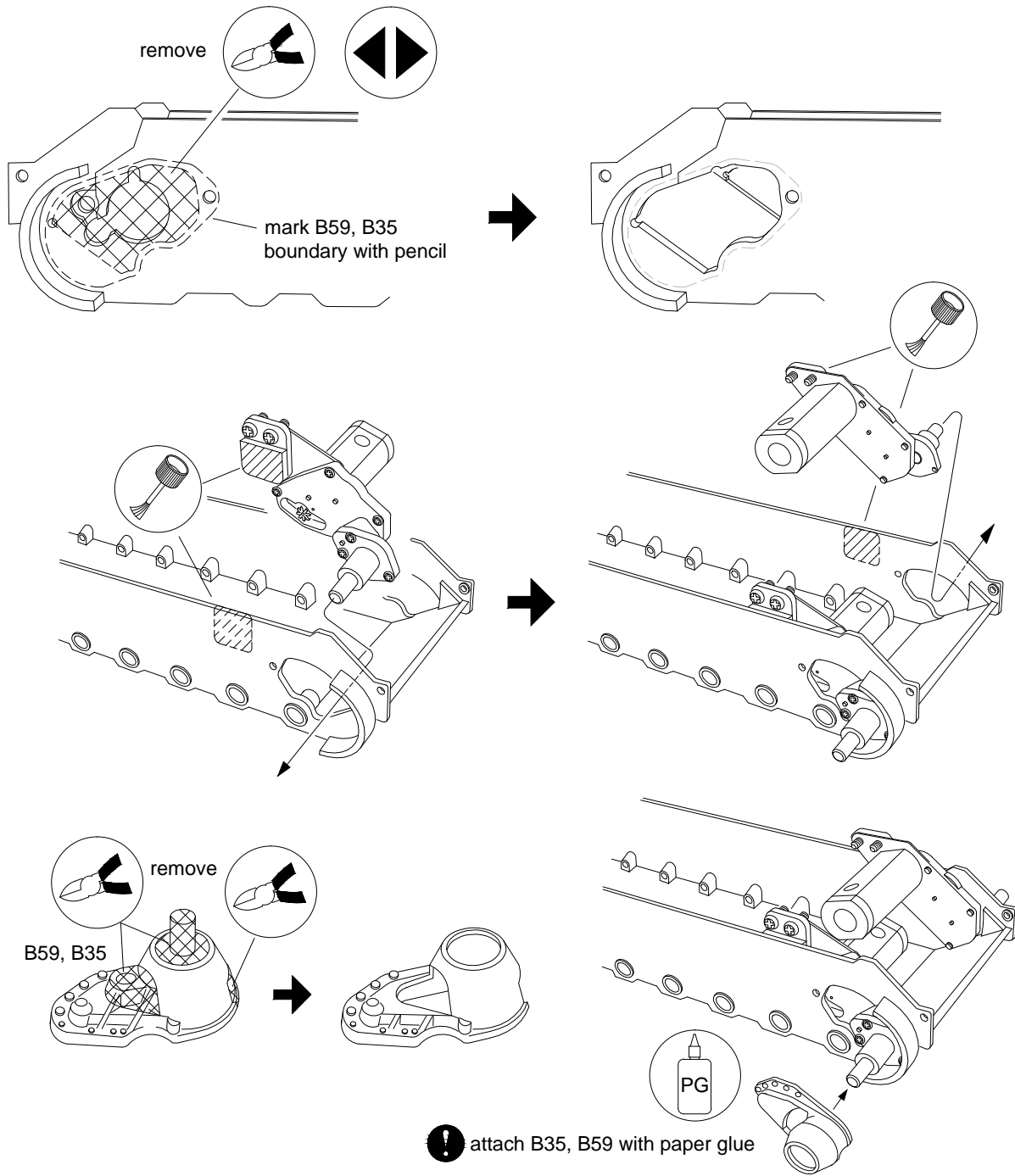

2 Torsion bar

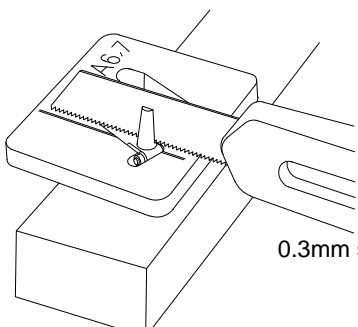
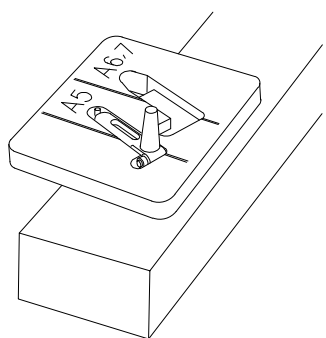
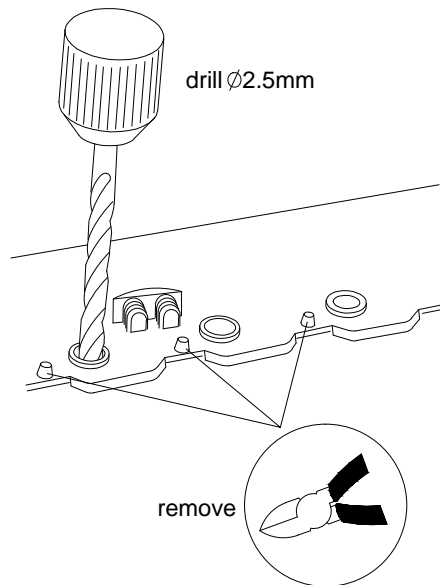
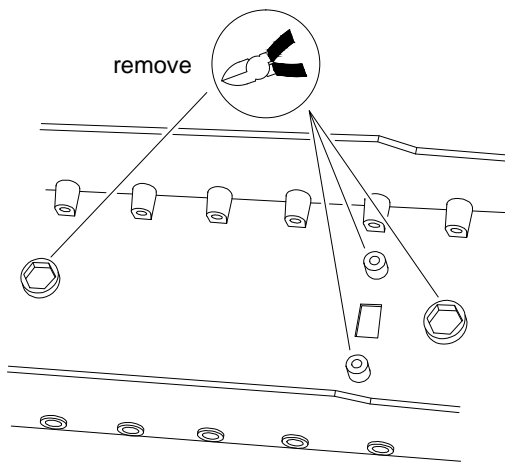

put torsion bars A5, A6, A7 into alignment jig

insert 0.3mm saw blade into cutter handle cut slot carefully along center line

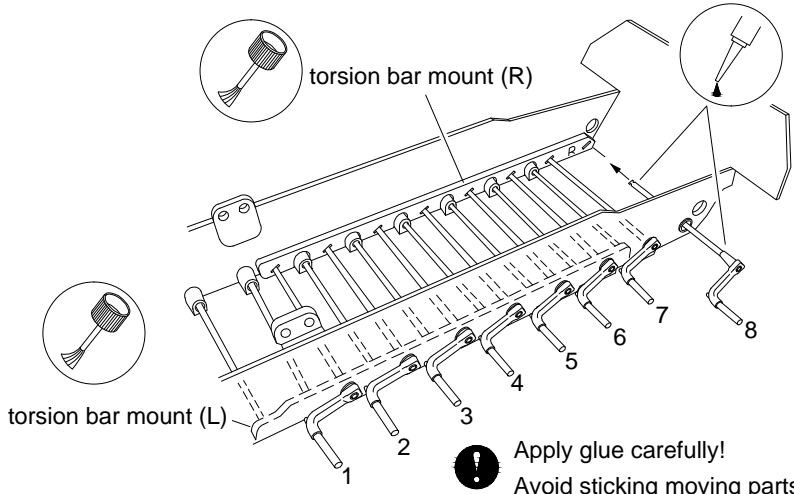
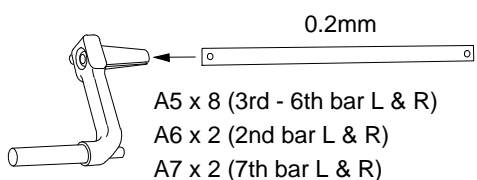
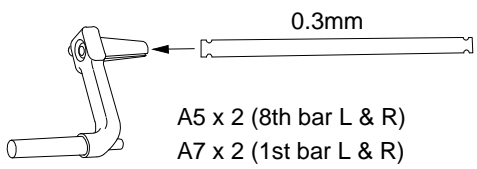

⚠ Rotate idler shaft to adjust track tension

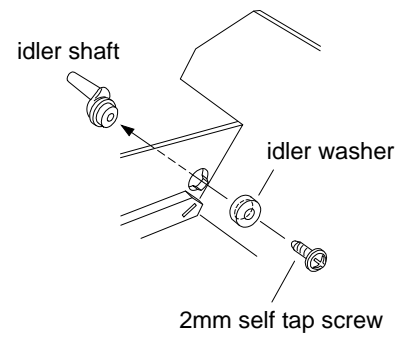

3 Turret

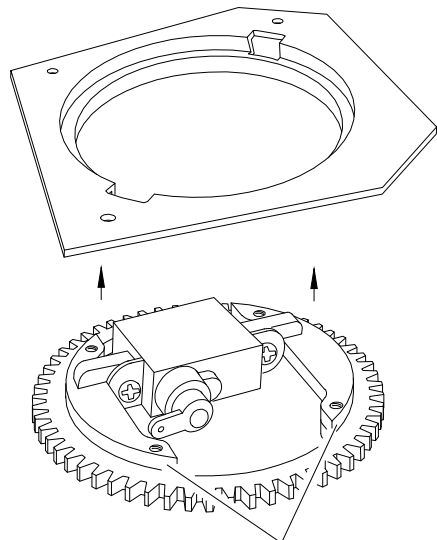
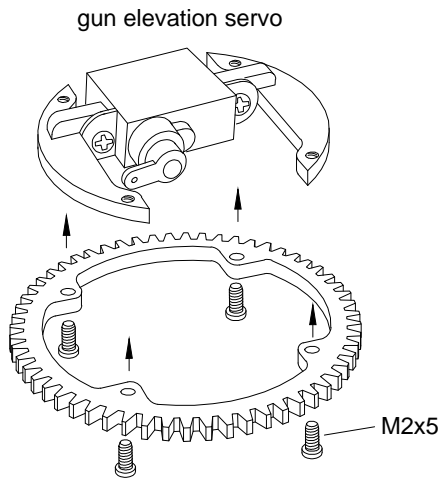
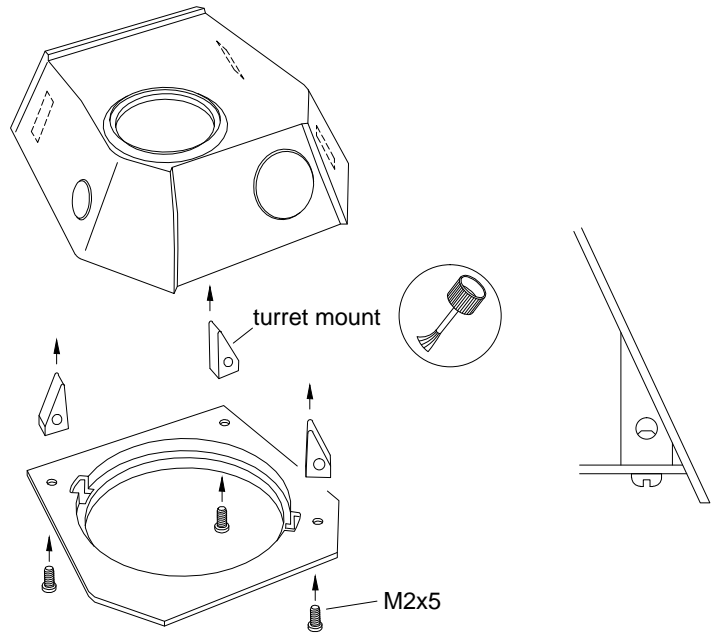
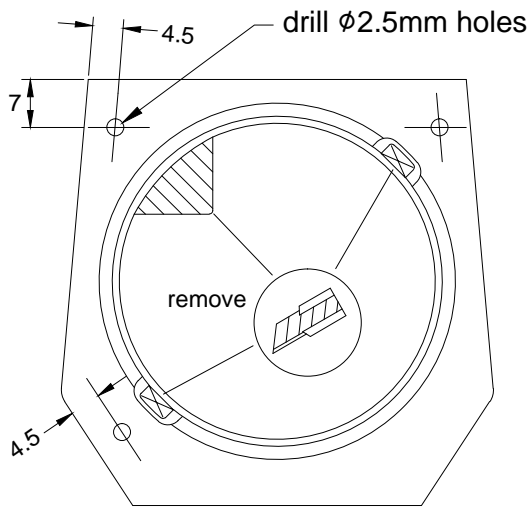

! apply glue to servo mount only!

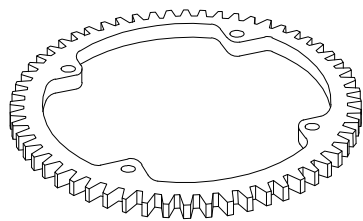
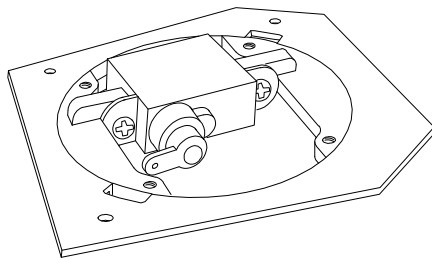
remove ring gear after glue is secured

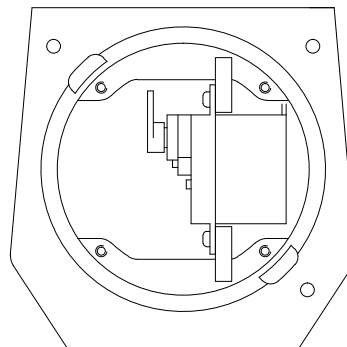

4 Main gun

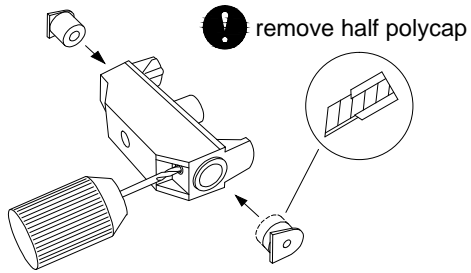

drill $\varnothing 1\text{mm}$ through on R side

remove

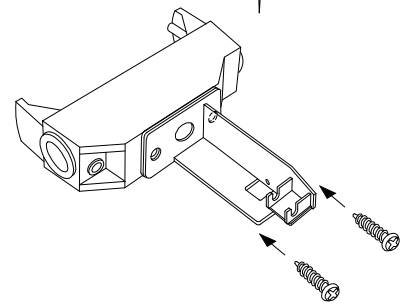
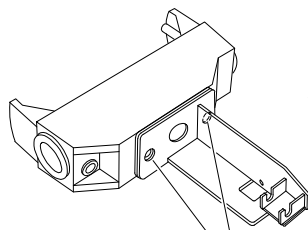
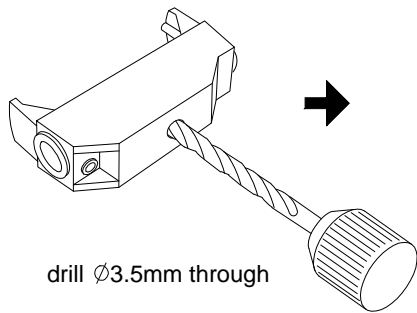
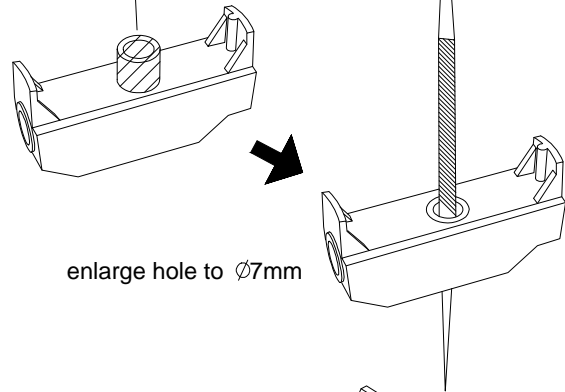

C12

enlarge hole to $\varnothing 6.5\text{mm}$

remove

muzzle brake

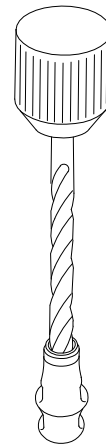

metal barrel

insert metal barrel

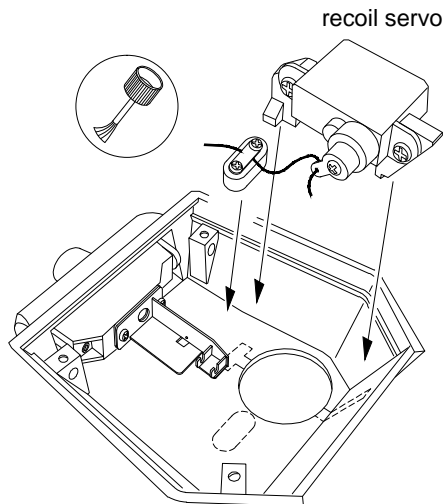

metal barrel

recoil spring

secure set screw

adjust recoil travel

5 Main gun and machine gun LEDs

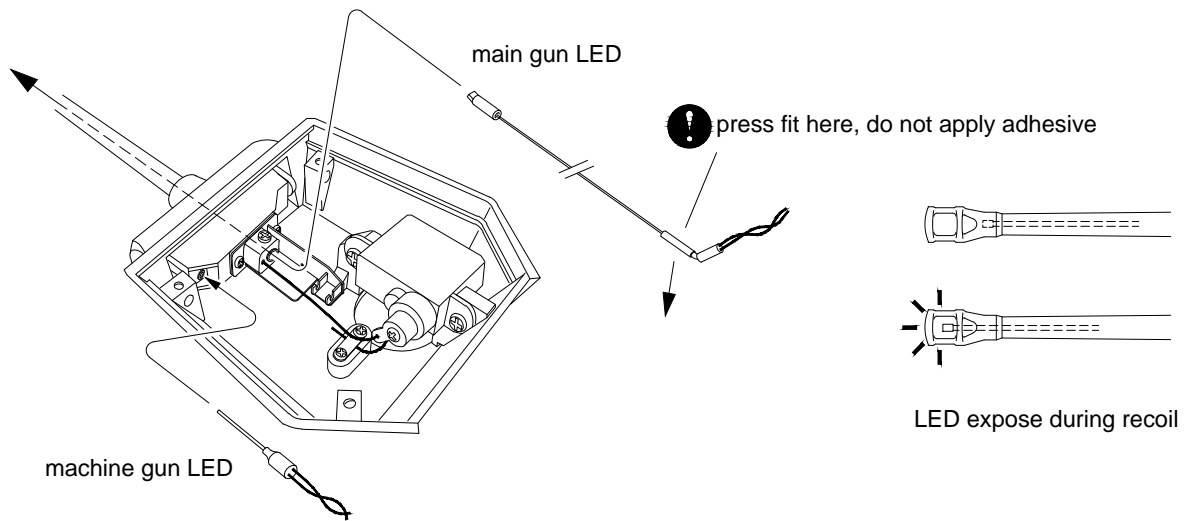

6 Gun elevation servo

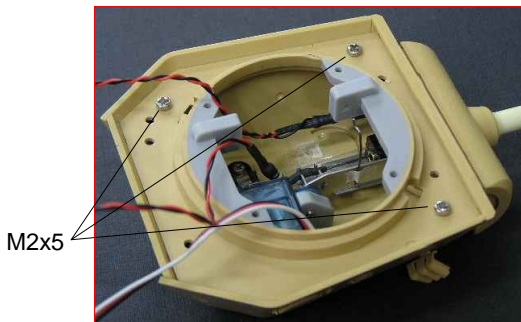

Step 1) remove gun elevation servo, attach turret base



Step 2) insert push rod to servo arm, secure servo with M2x5 screws

7 Attach turret



Step1) position turret to upper hull

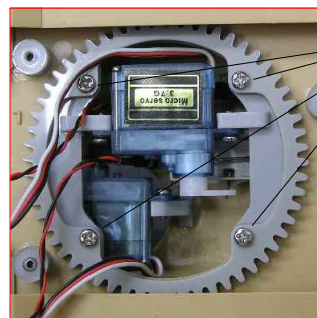

Step2) secure ring gear with M2x5 screws

8 Turret rotation servo and speaker

apply cement to mounting poles

! 0.5mm clearance between pinion and ring gear

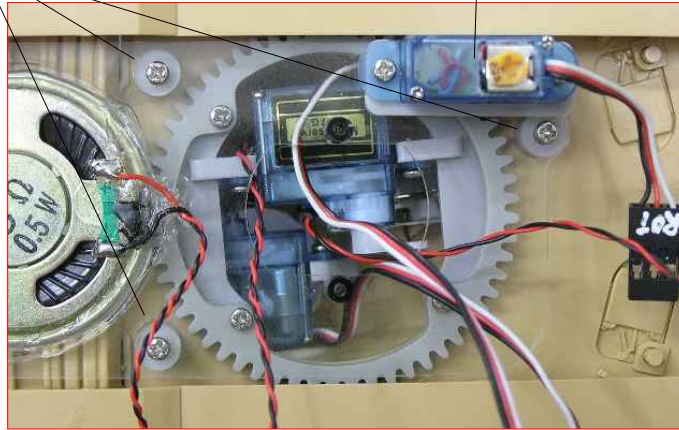

9 Install ACU

secure ACU with M1.7 screws



10 Connecting 1 Cell Lipo battery

! Lipo battery can be dangerous if not use properly! Follow all safety precautions and always use a dedicated Lipo charger.

Keep original connector for charging.



- ! 1) solder cables and wrap with heat shrink tubing
- 2) to avoid short circuit, solder and wrap one cable at a time



1Cell (3.7V) Lipo battery (300-1500mAh)

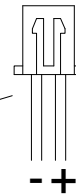

! MTC-2 power connector
MTC-2 will damage if polarity is not correct!

11 Lower hull connections

1 Cell/ 3.7V Lipo



Spektrum 2.4G AR6110e
micro receiver

secure MTC-2
by M2 x 3 screws