

RC Conversion Kit for Tamiya 1/35 M2A2 Bradley, with ACU

User Manual

(Version 2.0)

Attention!

- 1) This kit is designed for experienced model makers. It may be difficult for beginners. Please read this manual thoroughly to see if you have the required skills and tools.
- 2) Cutting tools are used frequently in this kit. Extra care should be taken to avoid injury. Wear hand gloves and eye protection spectacle if necessary.
- 3) Keep room well ventilated when working with cements, paints and organic solvents.
- 4) Visit www.35rctank.com for addition tips and update information.

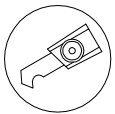

scriber



apply cement



side cutter



do not apply cement

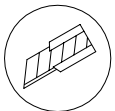

modelling knife

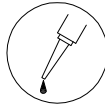

apply instant glue



carving knife



do not apply instant glue

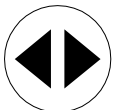

both sides



wait overnight



all purpose glue



solder



Attention!

1 Lower hull

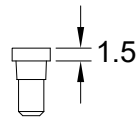
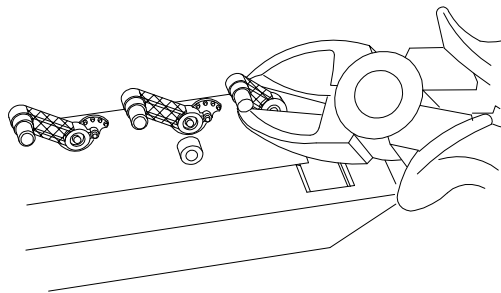
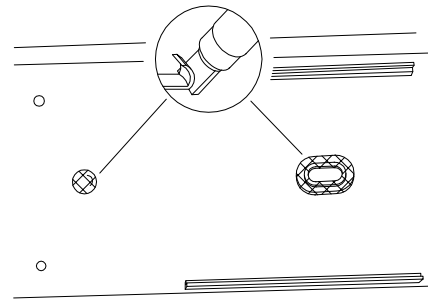
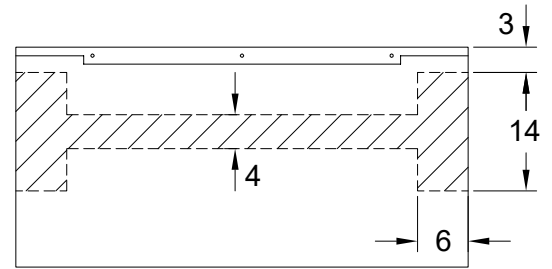
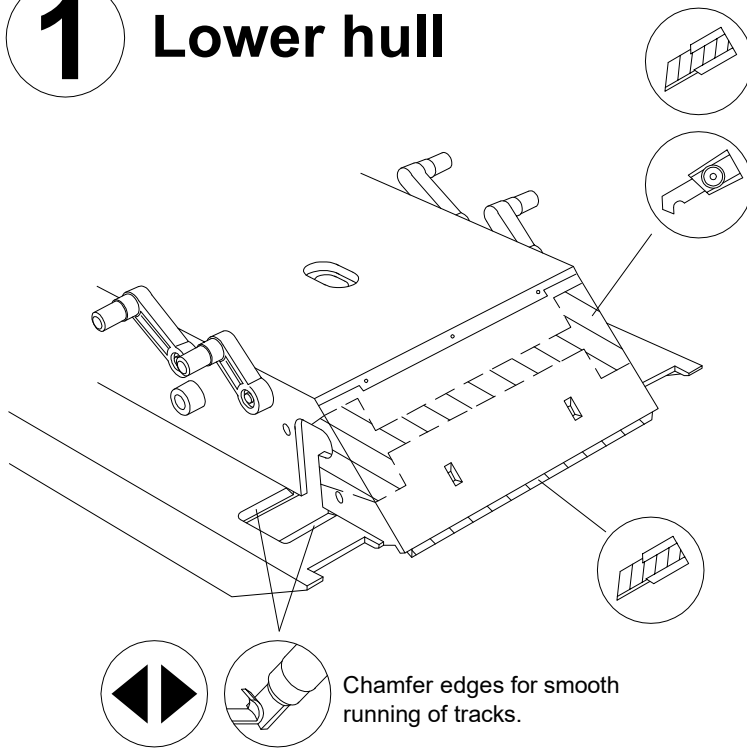

Drill $\varnothing 3\text{mm}$ holes

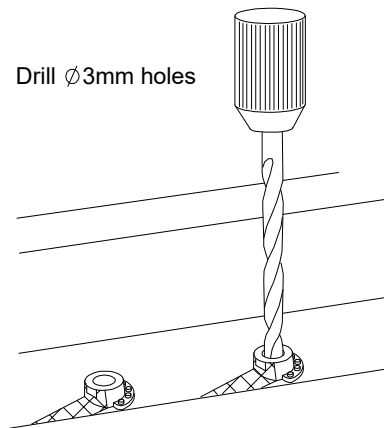

! Remove wheel shaft carefully. Collect 12 wheel shafts for later use.

2 Idler wheel shaft

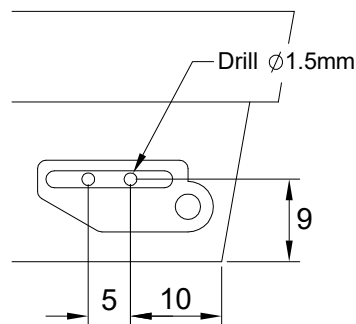
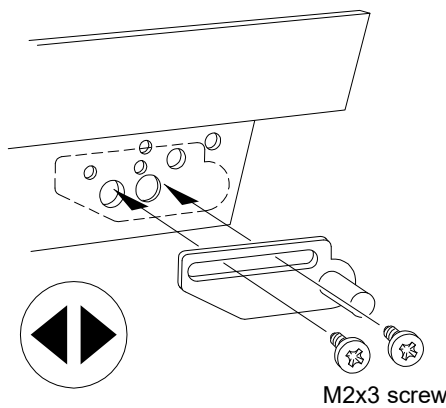

3 Suspension arms

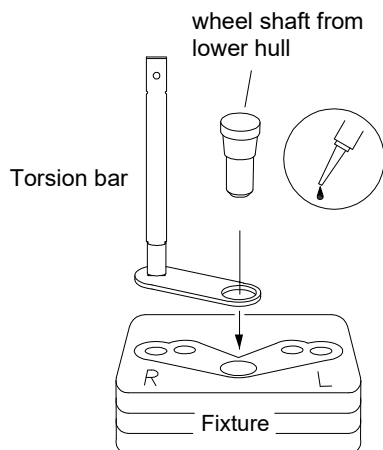

Place torsion bar on top of fixture. Note different position for left and right arms. Insert wheel shaft and apply instant glue carefully.

Attention - Too much glue will stick arm to fixture!



The suspension arms will tilt under loading. The shaft is tilt in purpose for compensation.

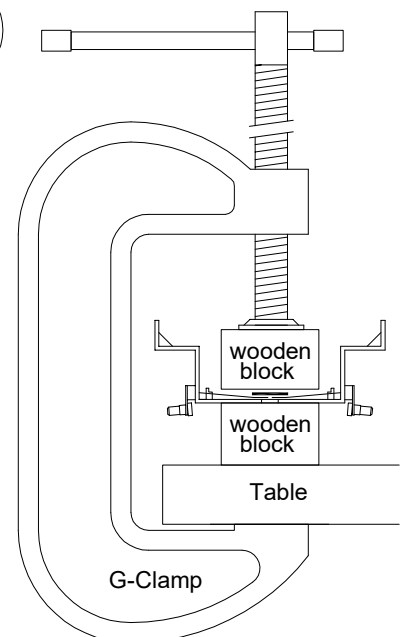
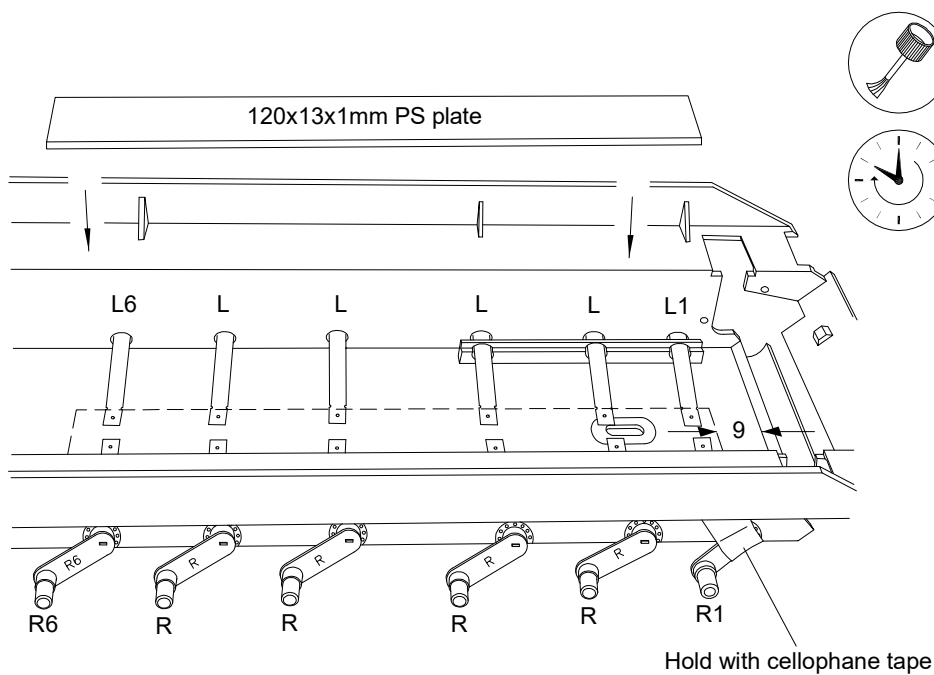

Use G-clamp or apply weights



- 1) Hold all suspension arms with cellophane tape.
- 2) Cut 1mm PS plate. Apply lots of cement to PS plate and lower hull.
- 3) Use G-clamp or add weights to press PS plate firmly to lower hull.
- 4) Wait till cement has cured completely.



Attention - Do not use instant glue! It will spread along torsion bars and stick suspension arms.

4 Motor and sprocket

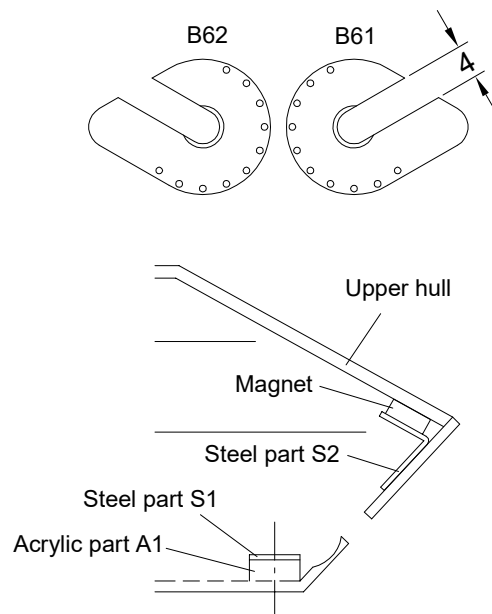
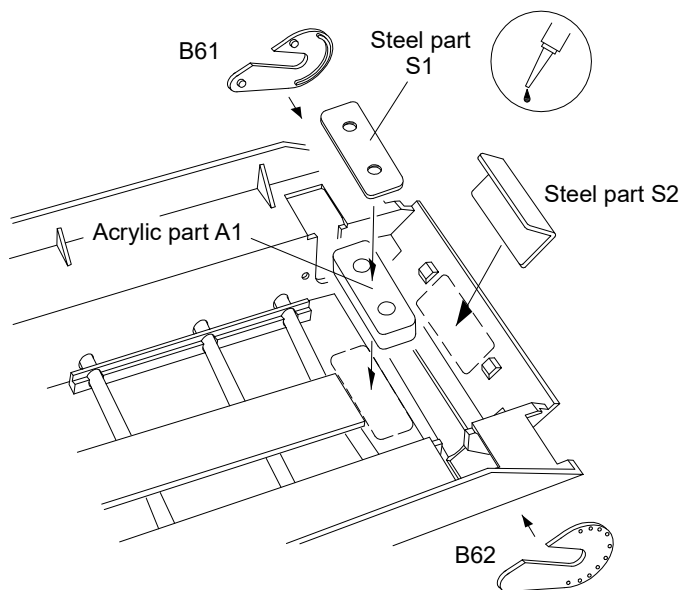

⚠ Position A1, S1 at centre line of lower hull.
Avoid instant glue entering screw thread.

6mm hexagonal nut

Friulmodel sprocket mount

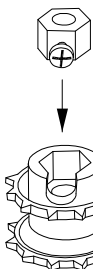

TAMIYA sprocket
Drill Ø3mm hole and
cut slot for set screw

Friulmodel sprocket
(ATL-78, ATL-79)

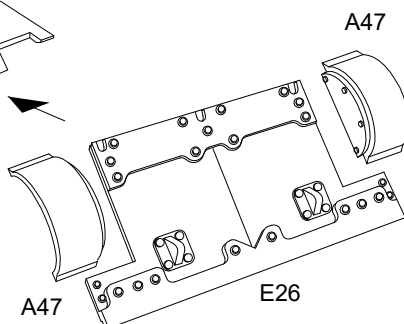
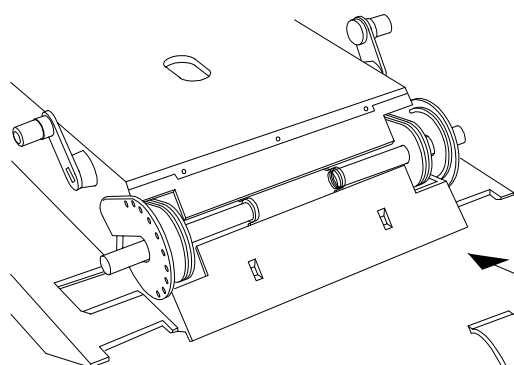
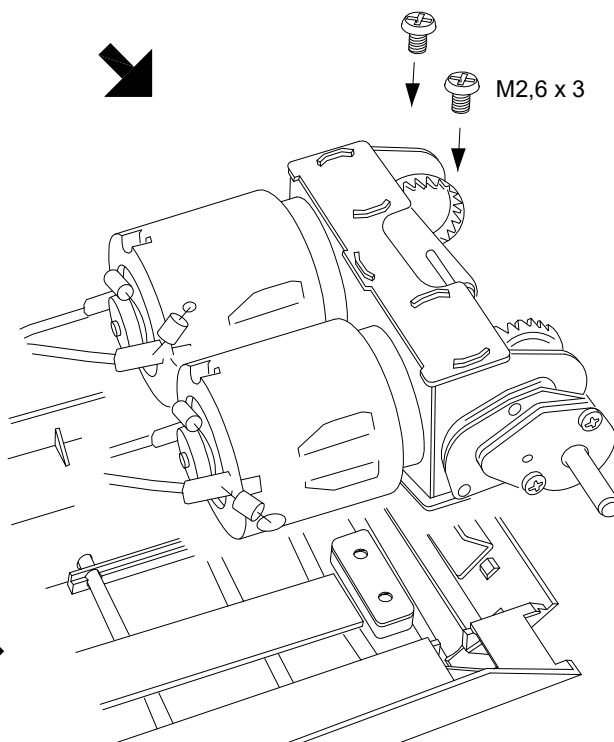

5 Machine gun LEDs

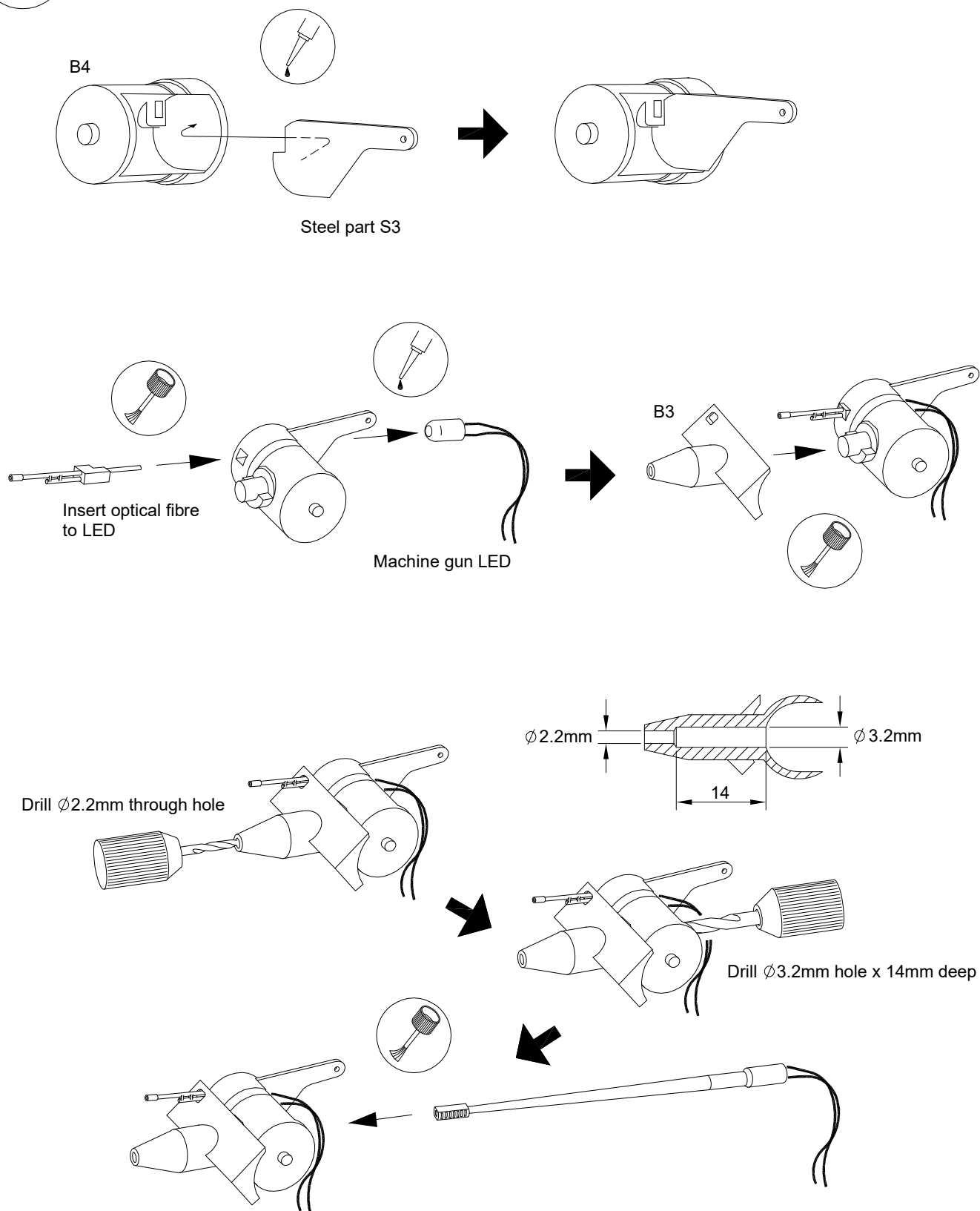

6 Turret

C2+C3

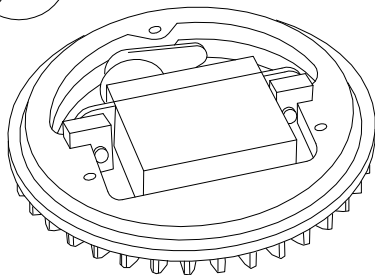
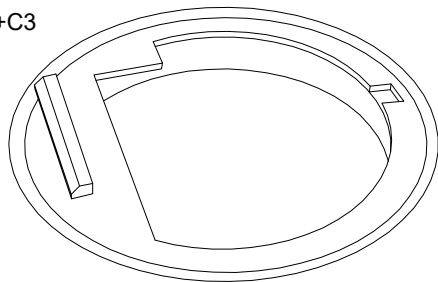

gun elevation servo
and ring gear

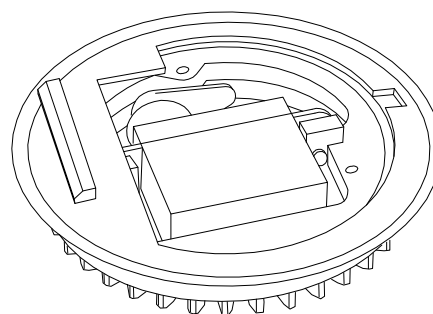

Remove ring gear

! Do not apply glue to ring gear! Remove ring gear after gun elevation servo is attached.

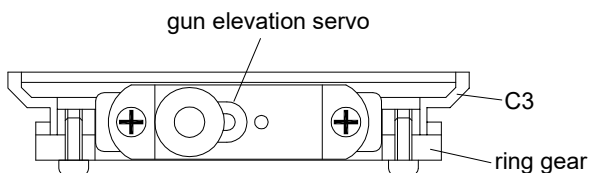

gun elevation servo

C3

ring gear



1) remove servo, insert push rod

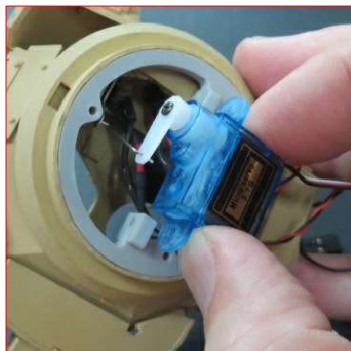

2) secure servo in position

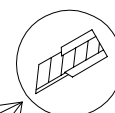
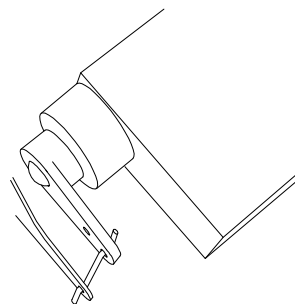

Remove



Do not attach B7, F8

7 Turret motor, ACU and speaker

1) insert turret to upper hull, secure ring gear

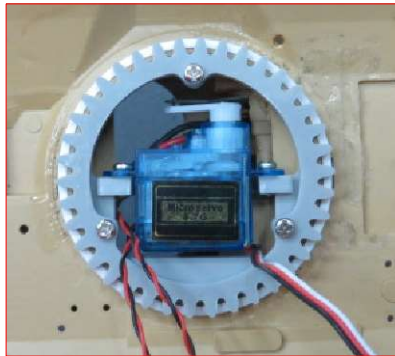

2) place turret motor assembly in position and apply glue

! keep 0.5mm space between ring gear and pinion!

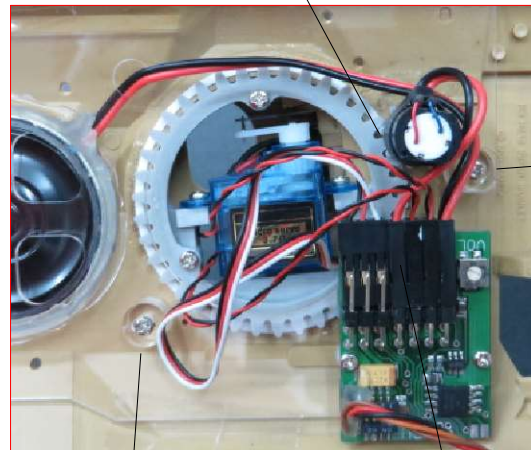

apply glue

apply glue

connect ACU cables

8 Install MTC-2 mini tank controller



MTC-2 mount

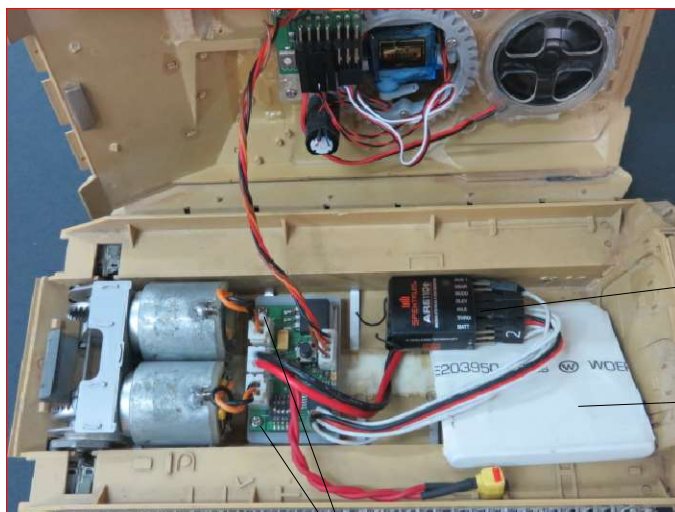

Spektrum 2.4G
AR6110e
micro receiver

1 Cell 3.7V Lipo battery
(300 - 1200mAh)

secure MTC-2 with M2 x 5 screw

9 Turret upper parts

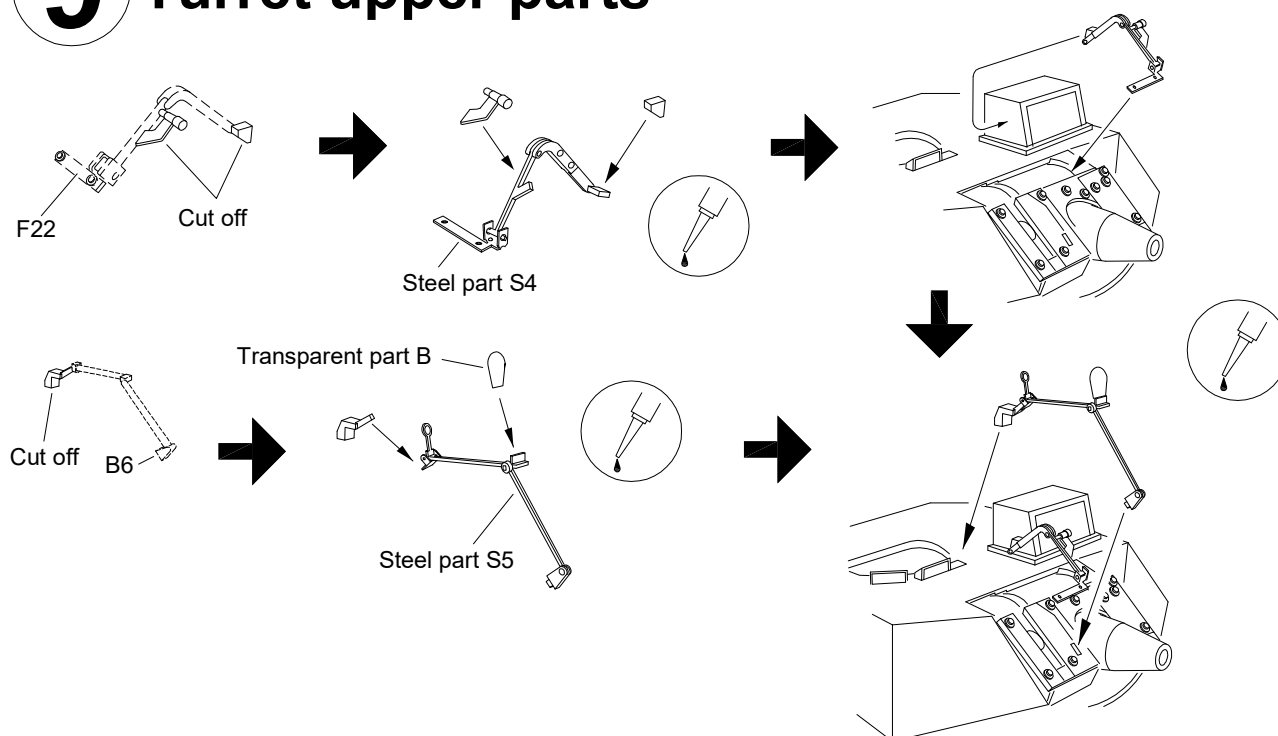

10 Connecting Lipo battery

⚠ Lipo battery can be dangerous if not use properly! Follow all safety precautions and always use a dedicated Lipo charger.

- 1) Use 3.7V/1Cell Lipo battery (300-1200mAh)
- 2) Make sure battery is small enough to put inside the lower hull.
- 3) Solder connector for MTC-2 as shown. Keep original connector for charging.

