

RC Conversion Kit for Freedom Model 1/16 Kettenkraftrad (Sd.kfz.2) (Item no: 16001)

User Manual (Version 1.0)

Attention!

- 1) This kit is designed for experienced model makers. It may be difficult for beginners. Please read this manual thoroughly to see if you have the required skills and tools.
- 2) Cutting tools are used frequently in this kit. Extra care should be taken to avoid injury. Wear hand gloves and eye protection spectacle if necessary.
- 3) Keep room well ventilated when working with cements, paints and organic solvents.
- 4) Visit www.35rctank.com for addition tips and update information.

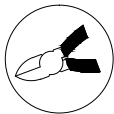

side cutter



apply cement

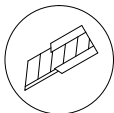

modelling knife



do not apply cement

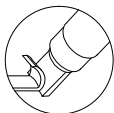

carving knife



apply instant glue



all purpose glue



solder

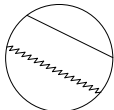

hand saw



apply lubrication oil

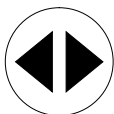

both sides

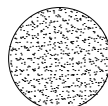

polish with sand paper



Attention!

1 Tracks

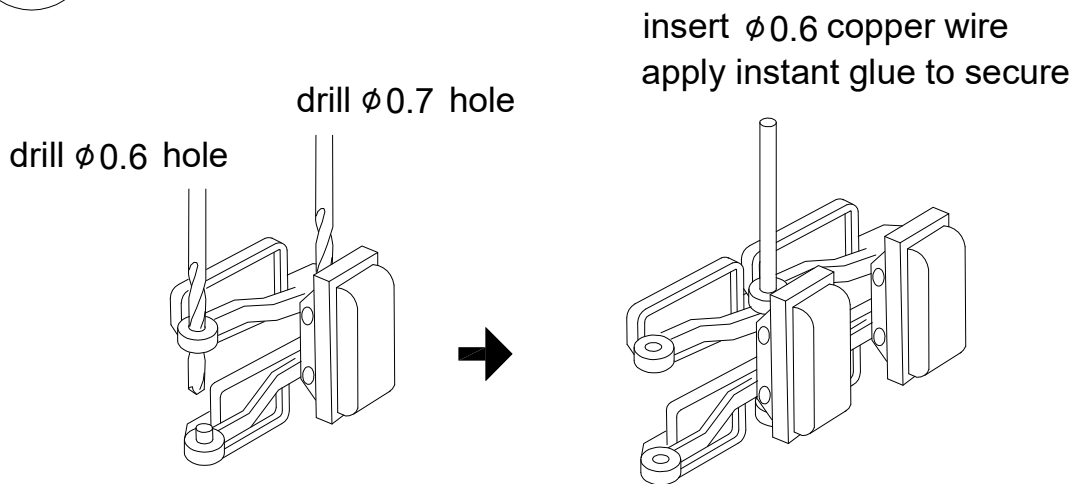

make 39 links for each track

2 Wheels

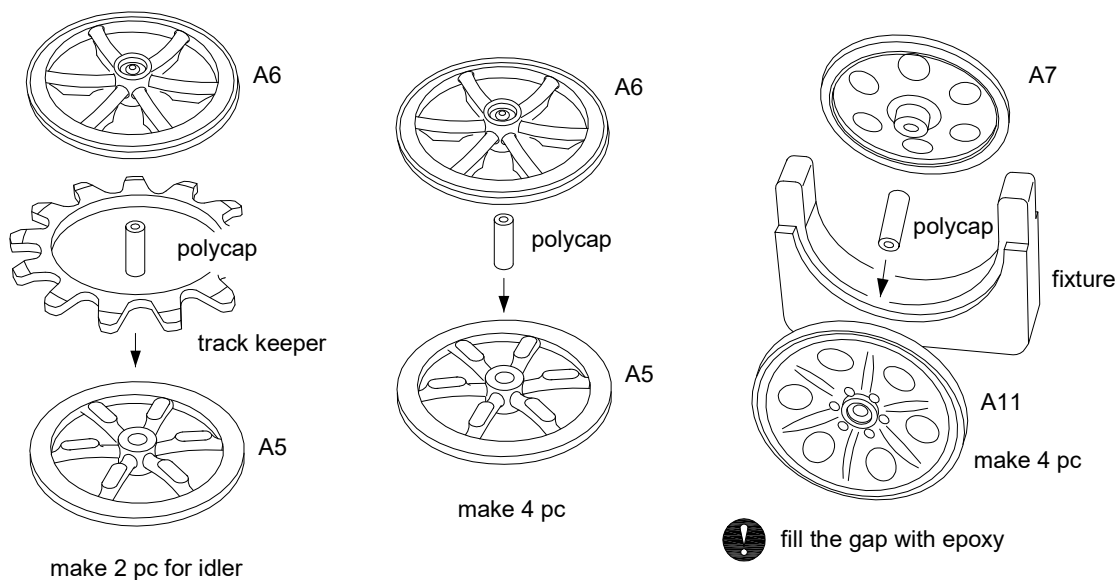
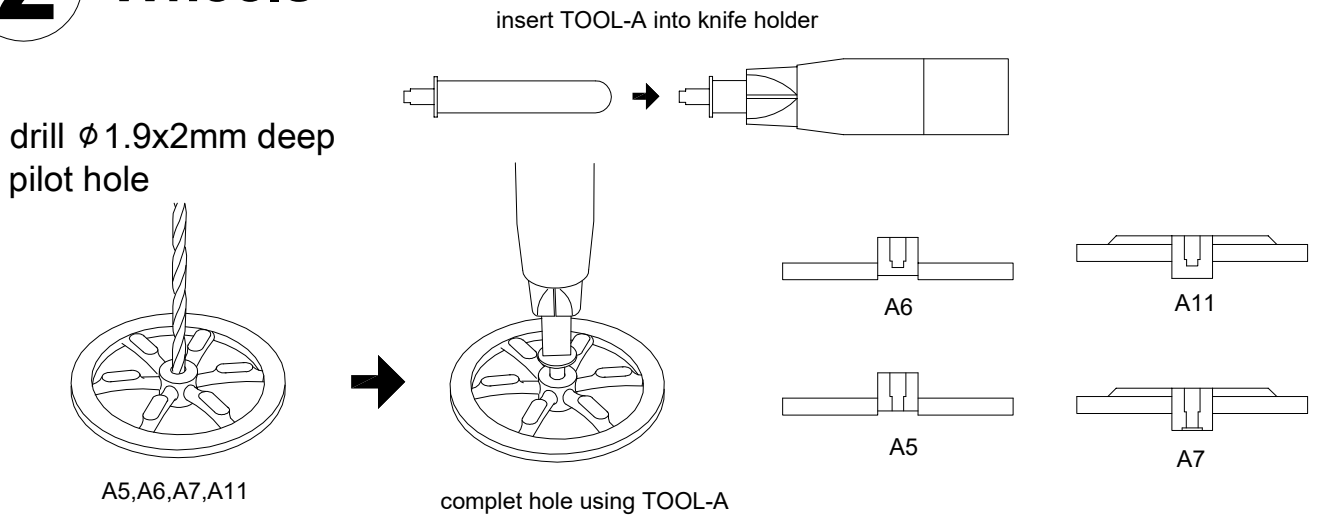

3 Lower hull

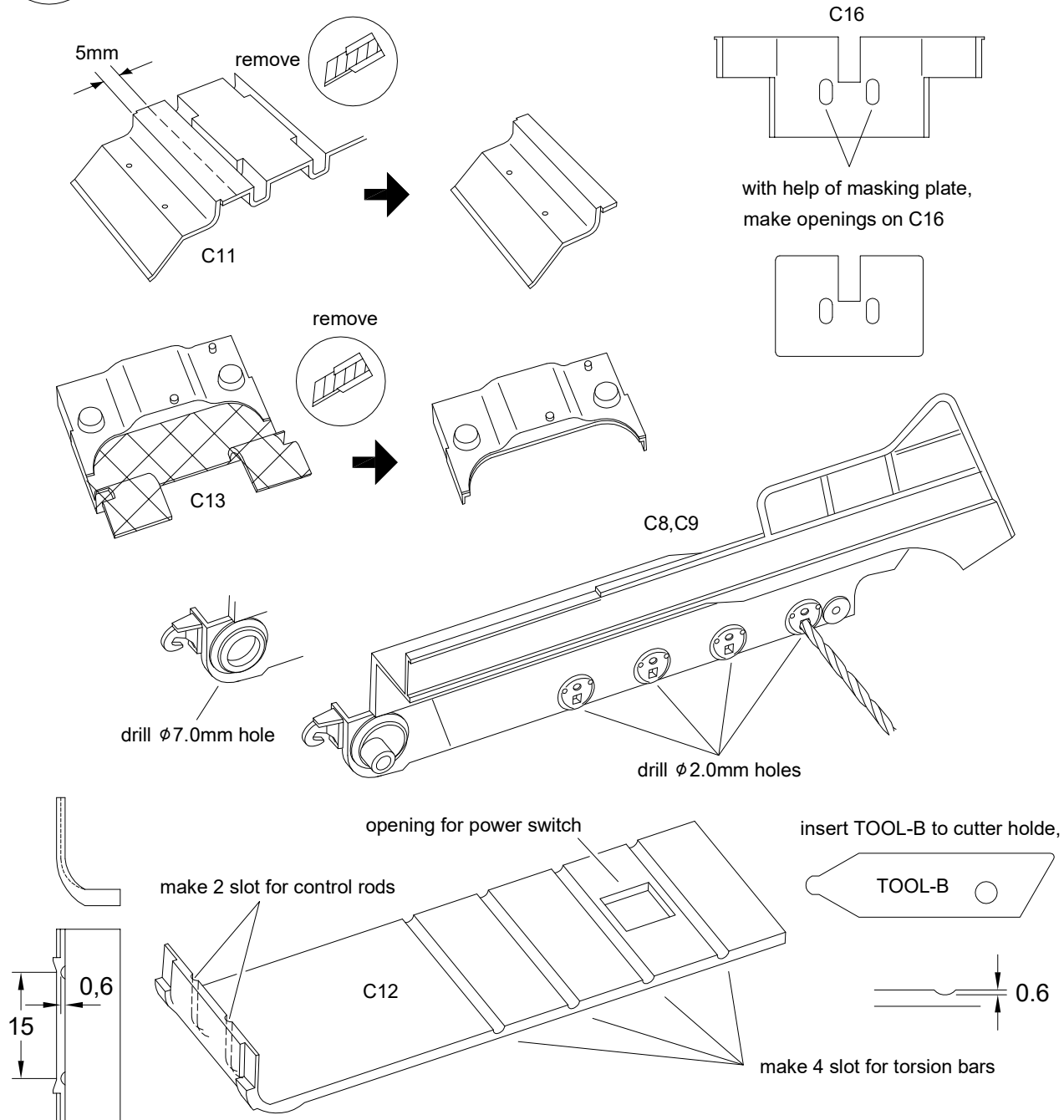

complete the lower hull as shown

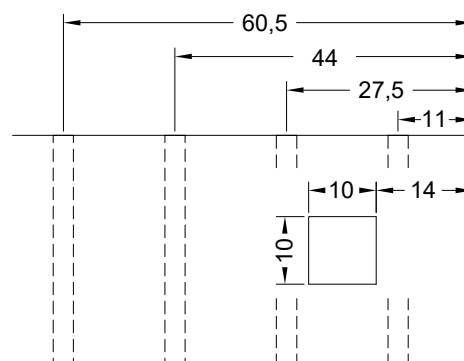

4 Torsion bars

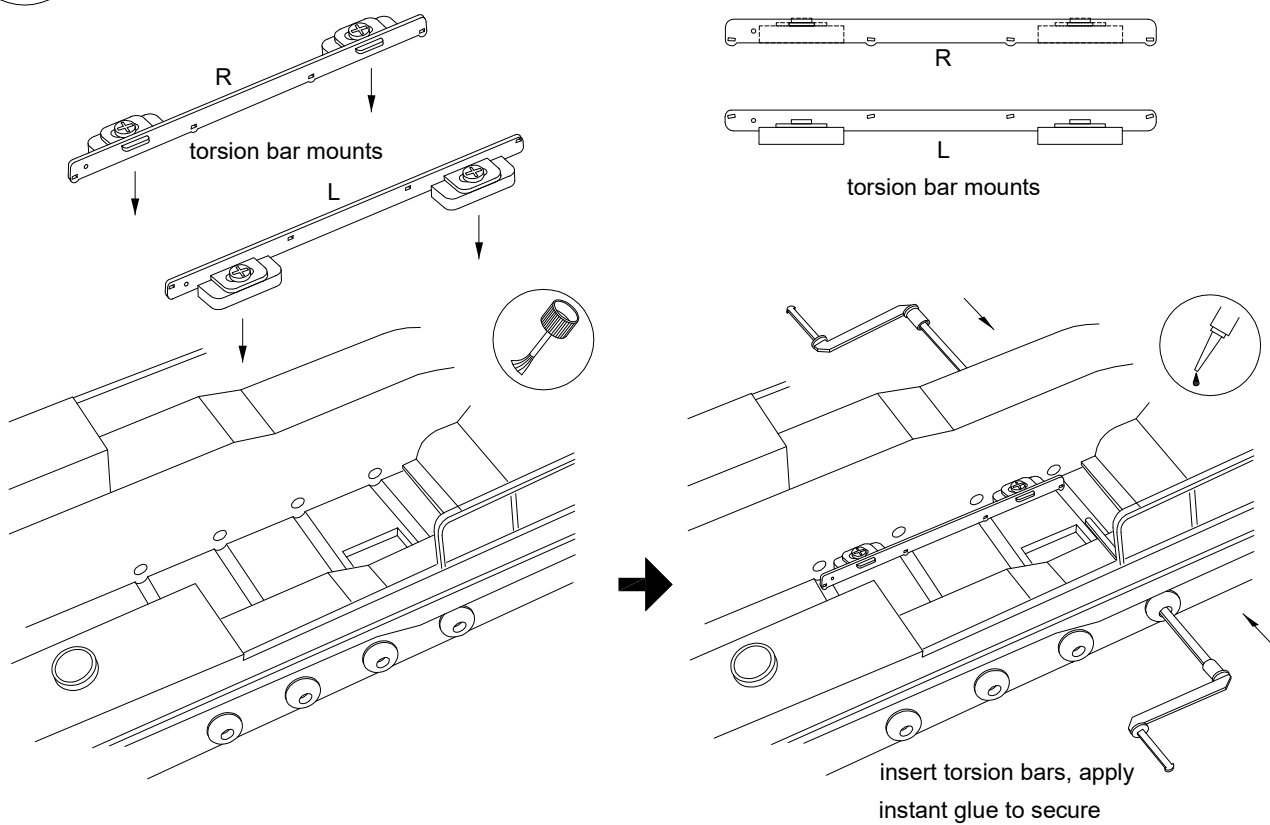

5 Idler wheels

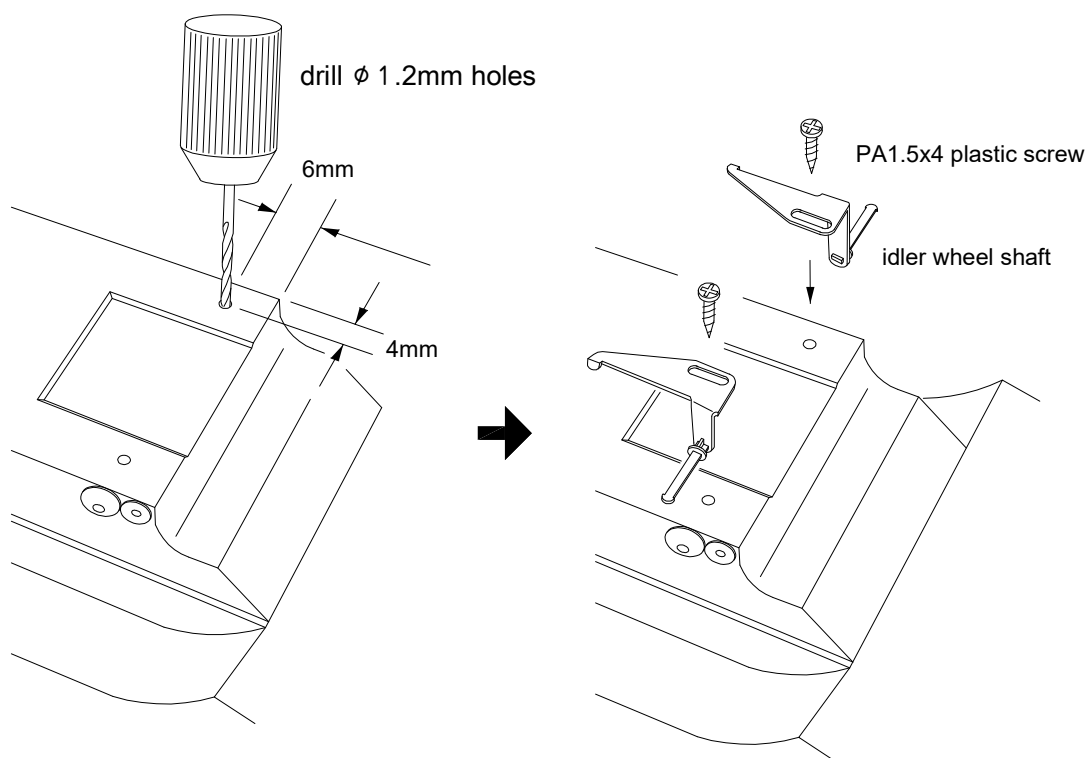

6 Motor assembly

make sure control rods in position



secure mounting plate with plastic glue

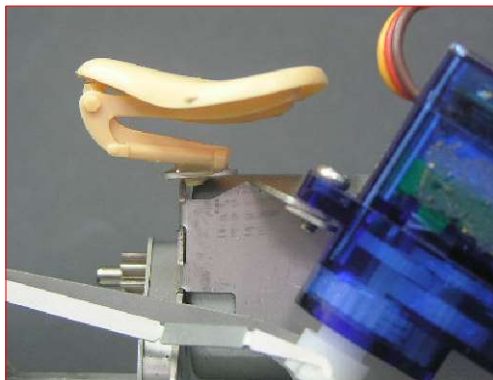
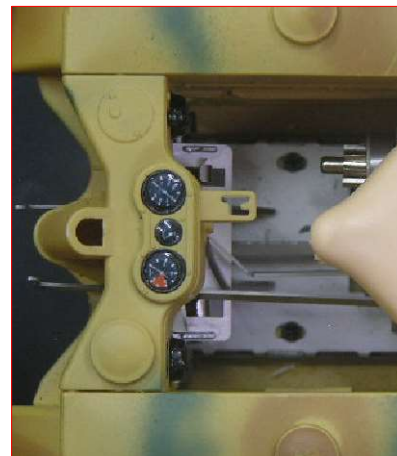
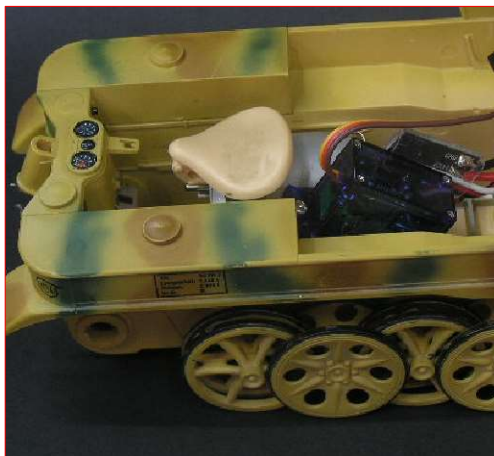

build and attach the seat as shown

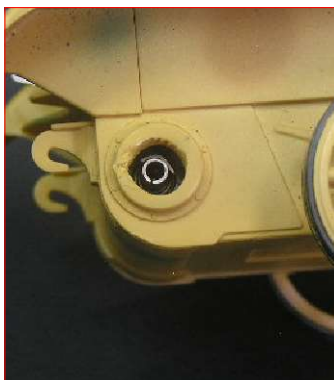

align wheel shaft at center



pass control rods out of hull

7 Steering wheel

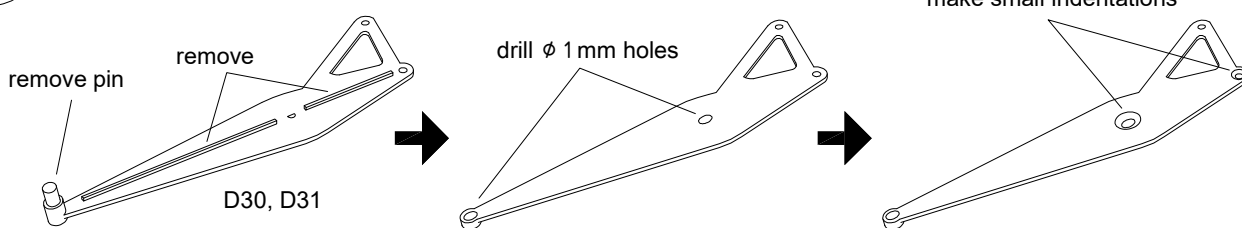

build the steering wheel,
drill ϕ 1.9mm hole



insert PIN-A, secure
with instant glue

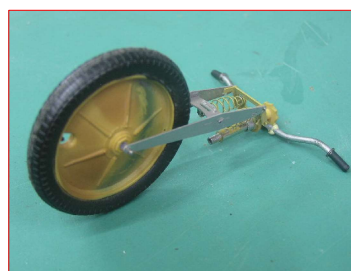

install the wheel

7 Steering wheel

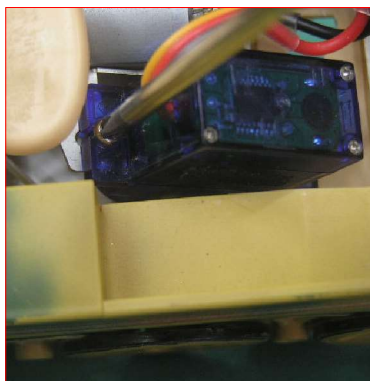

loosen servo screws

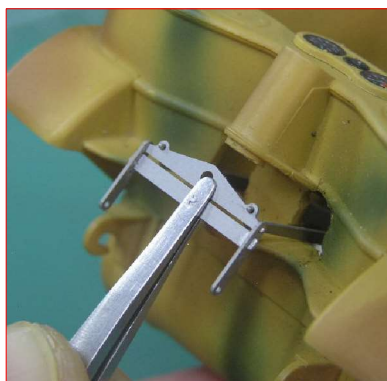

install PART-A to control rods

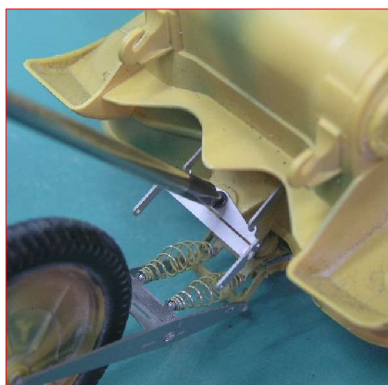
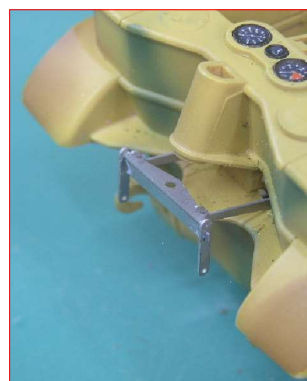

install front wheel
secure with M1.4x2.5 screw



PIN-B 
insert PIN-B to secure D30,D31
no glue is required



apply little instant glue
to secure PIN-B

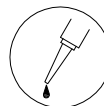

8 Sprocket and tracks

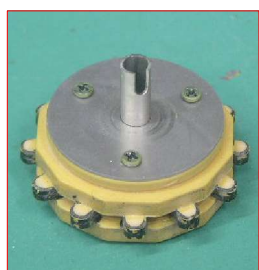

drill ϕ 1.2mm holes, secure
sprocket mount with PA 1.5x4
plastic screws

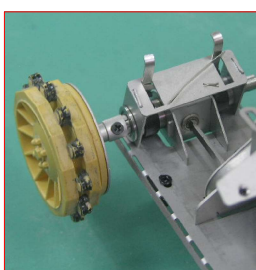

secure the M1.4 set screw
 do not miss the
the cylindrical washer!

9 Headlamp

apply aluminum sticker to make reflector surface

position the led at center,
drill $\varnothing 1.5\text{mm}$ hole for cable

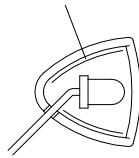

10 Wire connections

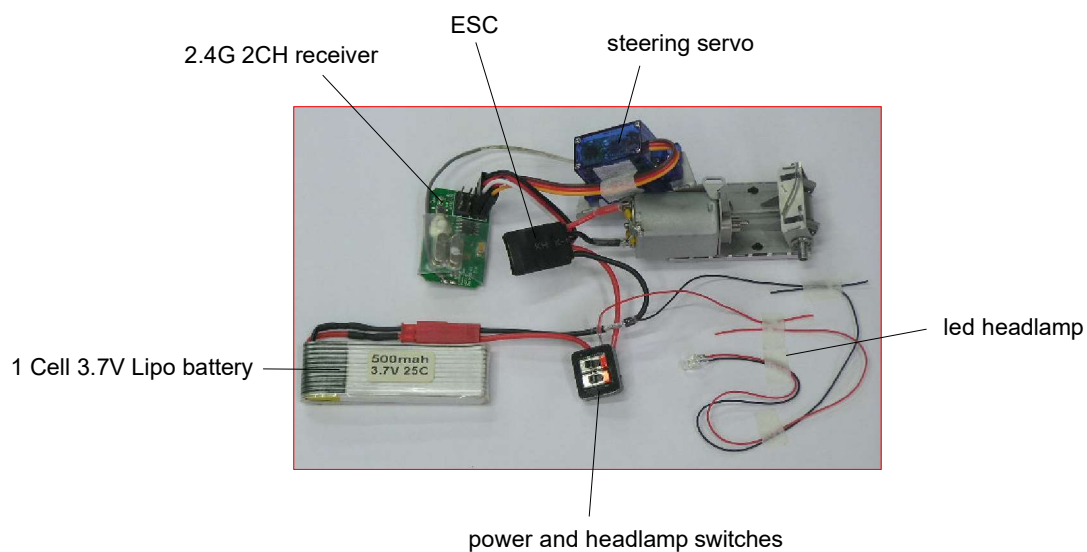

11 Driver figure



The driver is modified from a TAMIYA 1/16 figure



Use TAMIYA epoxy putty to modify shape

- 1) divide the body as shown
- 2) make movable joint with fishing line
- 3) heat and bend fingers to grip position
- 4) use epoxy putty to make a large ball joint
- 5) remove the foot



- 1) insert 0.5mm fishing line

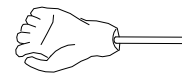

- 2) drill 0.7mm hole

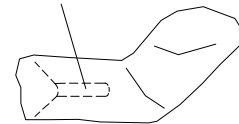

- 3) apply little instant glue at end of fishing line

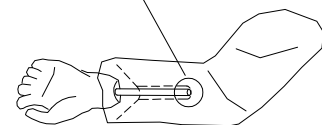

12 Using Lipo battery

⚠ Lipo battery can be dangerous if not use properly! Follow all safety precautions and always use a dedicated Lipo charger.

- 1) Use 3.7V/1Cell Lipo battery (500mAh)
- 2) Make sure battery is small enough to put inside the lower hull.
- 3) Solder connector as shown.

