

RC Conversion Kit for Panda 1/16

Pzkwfw 38(T) (Item no: 16001)

User Manual (Version 1.1)

Attention!

- 1) This kit is designed for experienced model makers. It may be difficult for beginners. Please read this manual thoroughly to see if you have the required skills and tools.
- 2) Cutting tools are used frequently in this kit. Extra care should be taken to avoid injury. Wear hand gloves and eye protection spectacle if necessary.
- 3) Keep room well ventilated when working with cements, paints and organic solvents.
- 4) Visit www.35rctank.com for addition tips and update information.

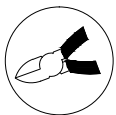

side cutter



apply cement

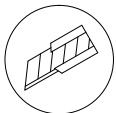

modelling knife



do not apply cement

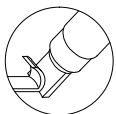

carving knife



apply instant glue



all purpose glue



solder

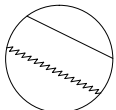

hand saw



apply lubrication oil

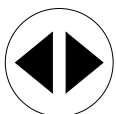

both sides

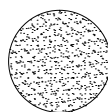

polish with sand paper



Attention!

1 Track

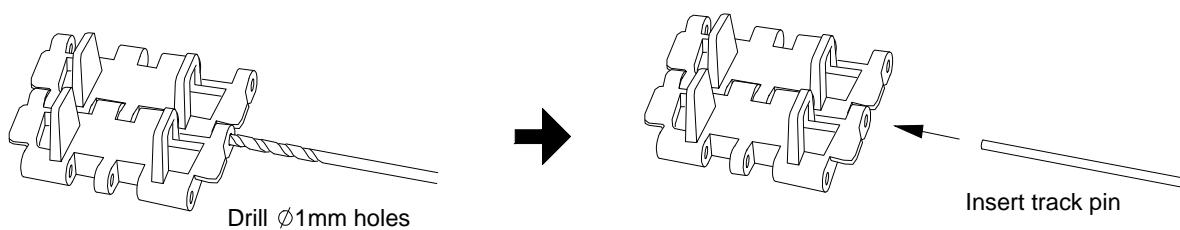

! Attention!
- Make end caps with original plastic pins, sprue or plastic rod

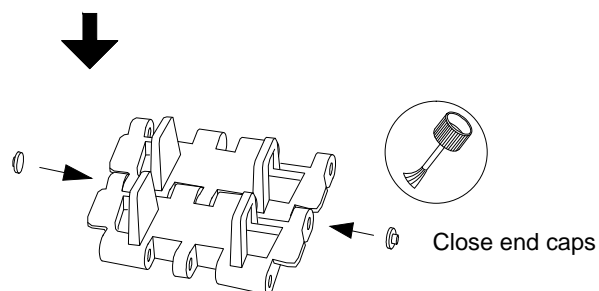

2 Leaf spring

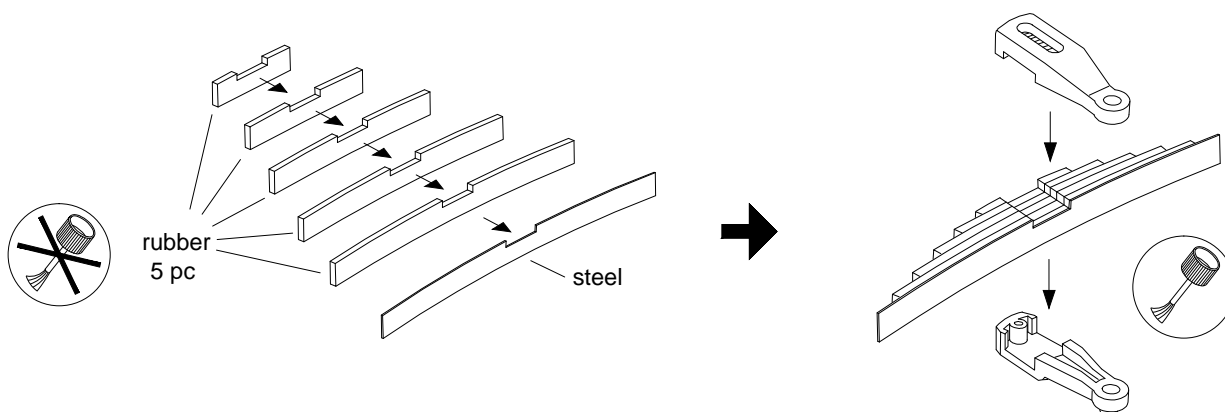
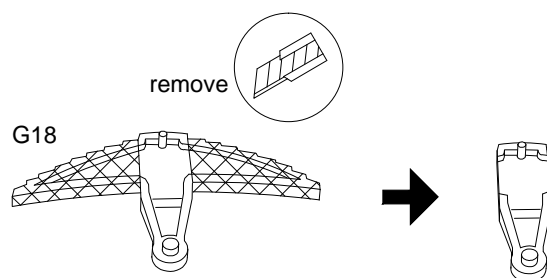
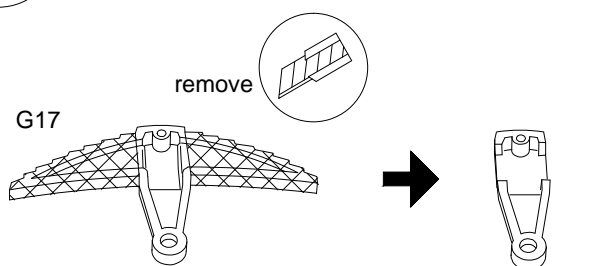

3 Idlers wheels

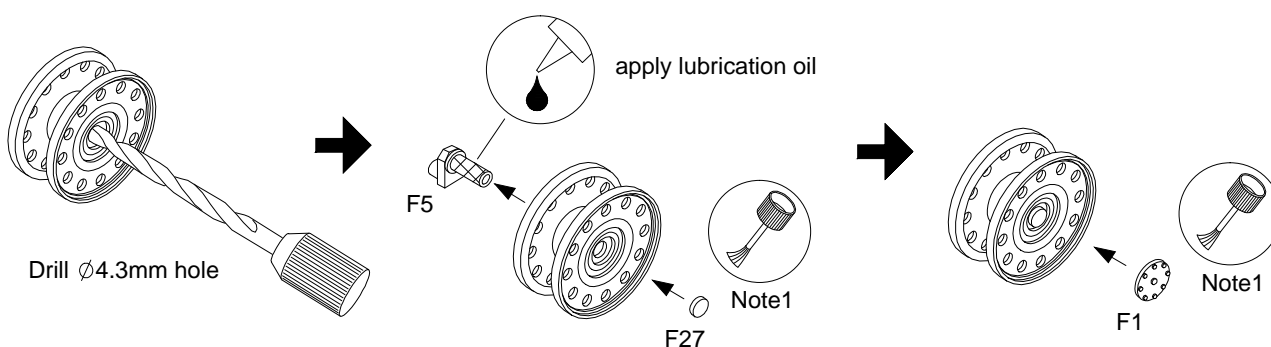

! Note1 - Apply cement carefully! Avoid sticking moving parts!

4 Wheels

Enlarge the gap here for smooth wheel rotation

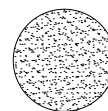
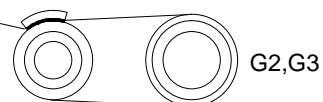

Reinforce G15 with 1mm PS plate

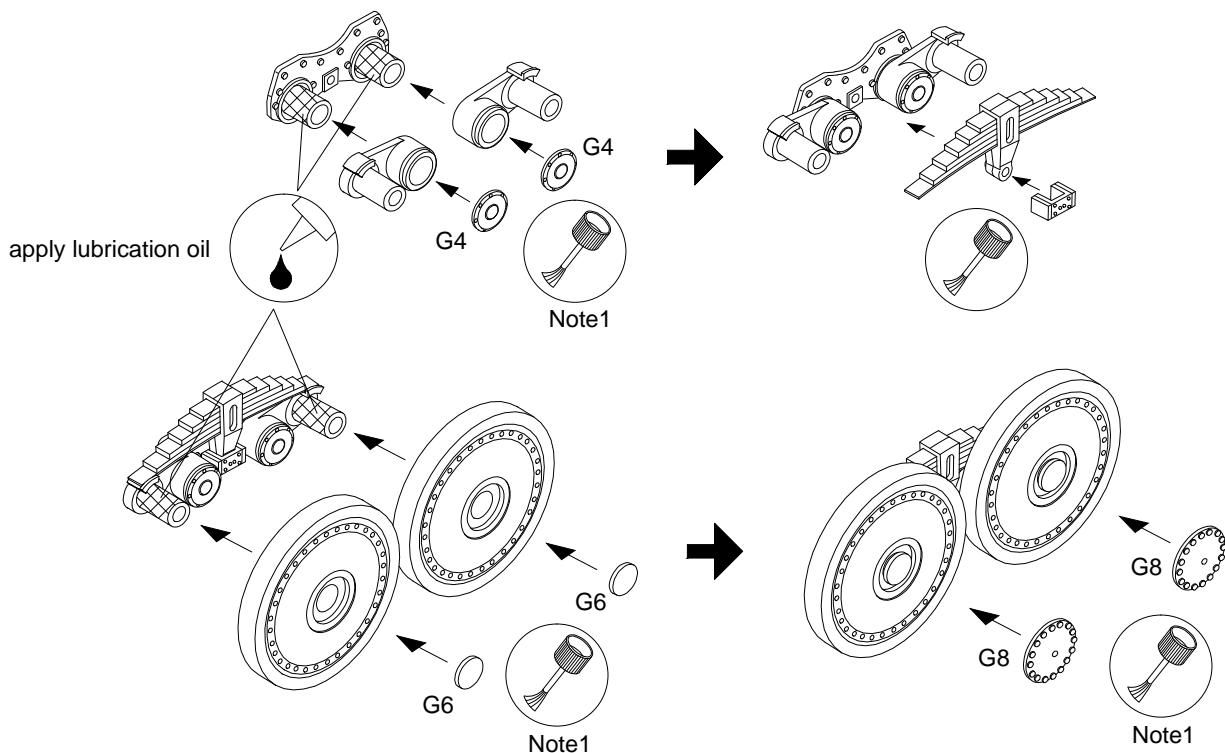
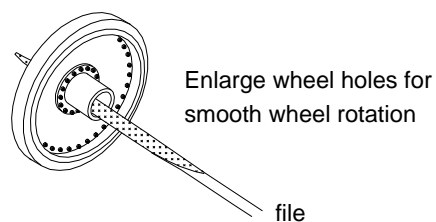
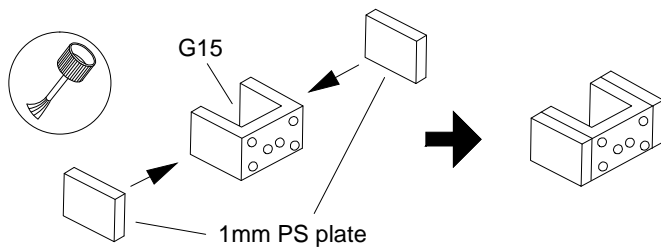

! Note1 - Apply cement carefully! Avoid sticking moving parts!

5 Lower hull

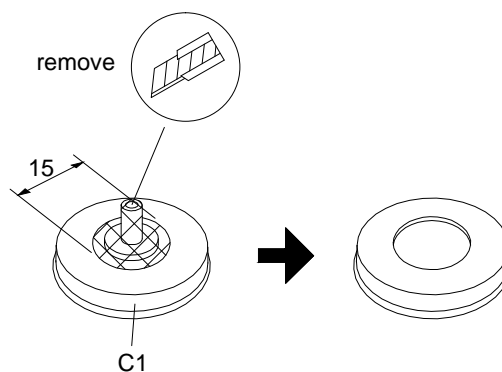
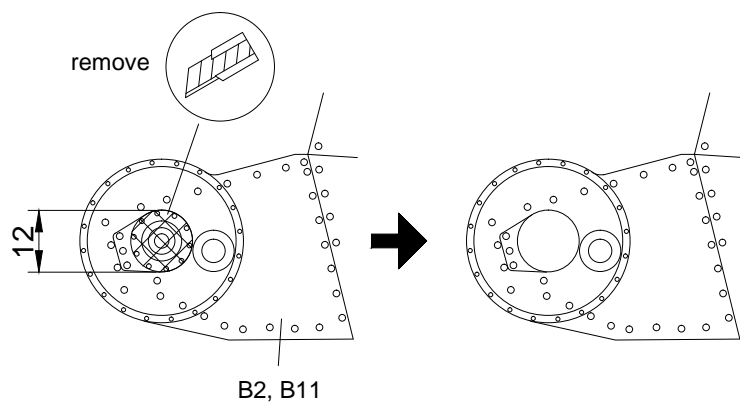

5 Lower hull

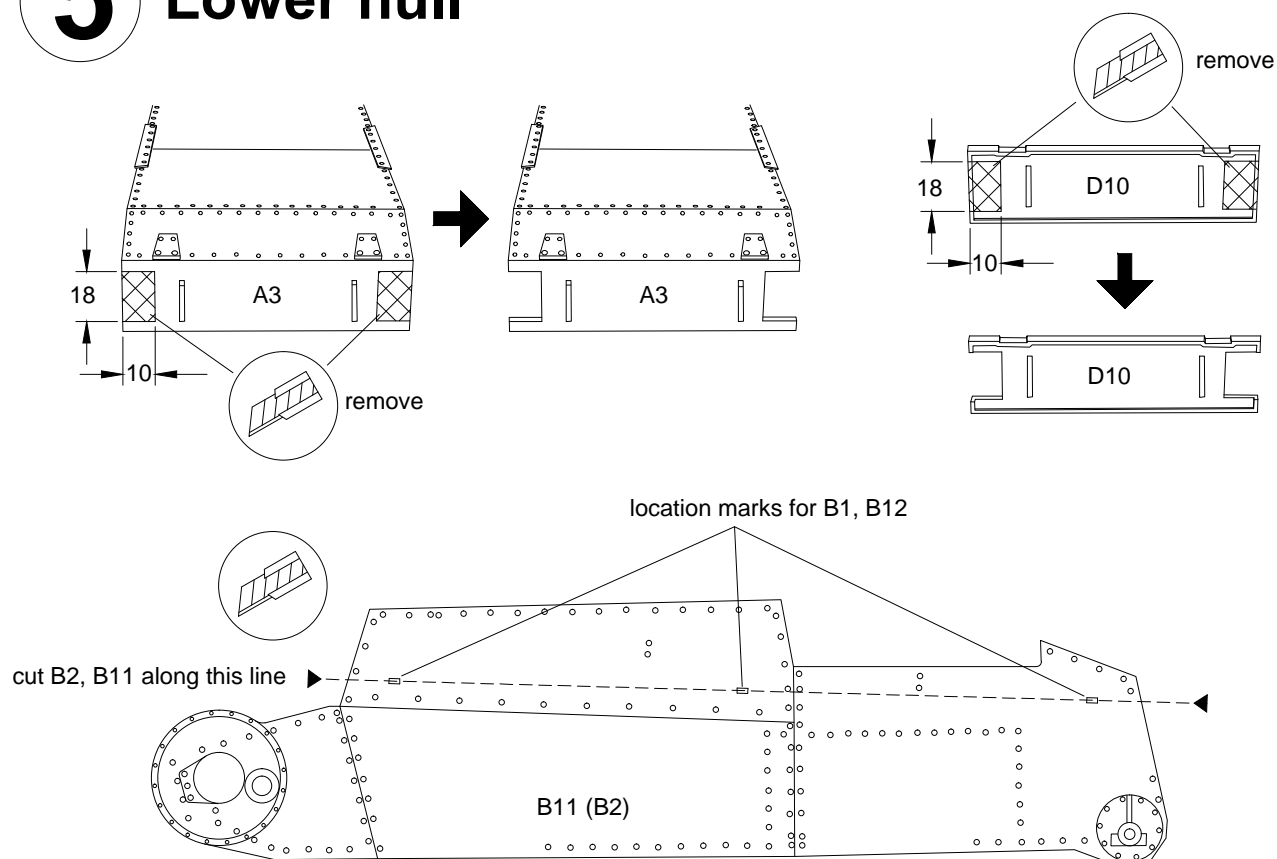

Build lower hull as shown

6 Upper hull

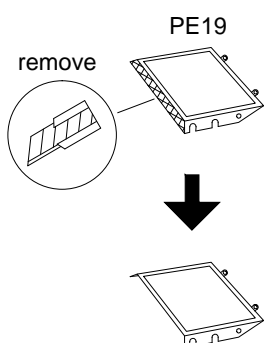

Build upper hull as shown

7 Gearbox

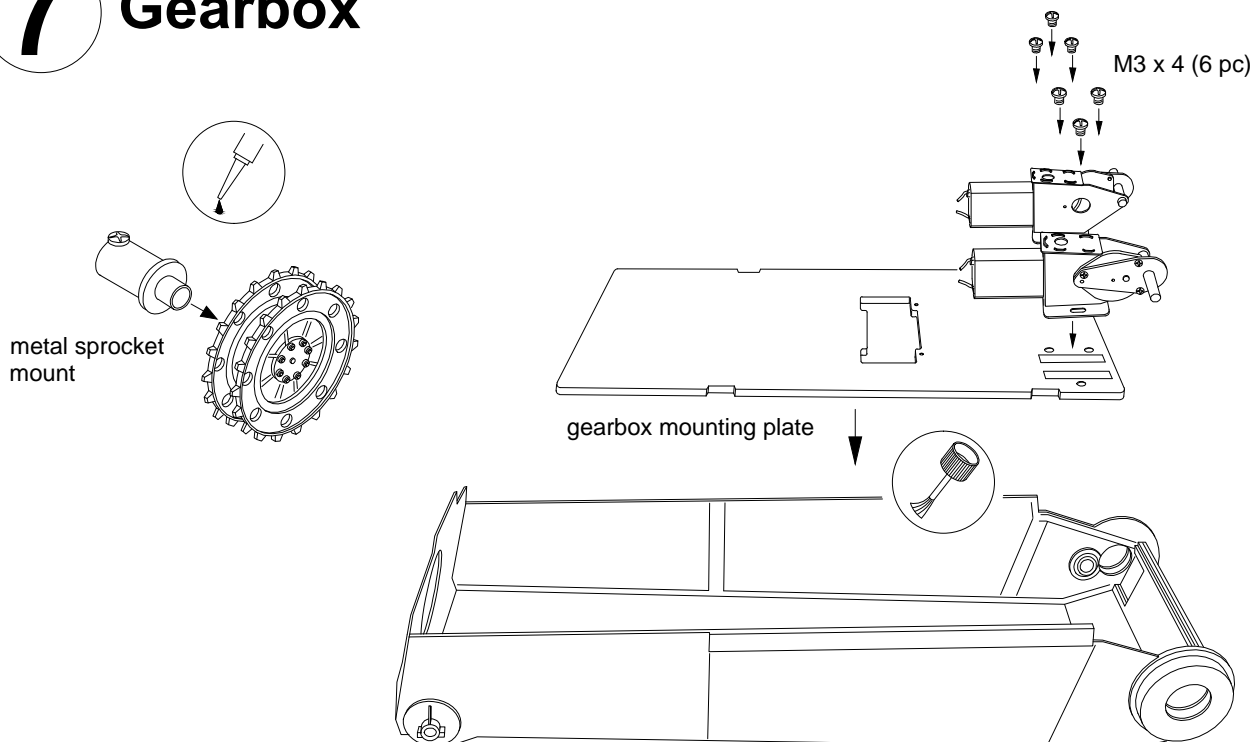

8 Turret ring gear

! To have a smooth turret rotation, the ring gear must align accurately with turret

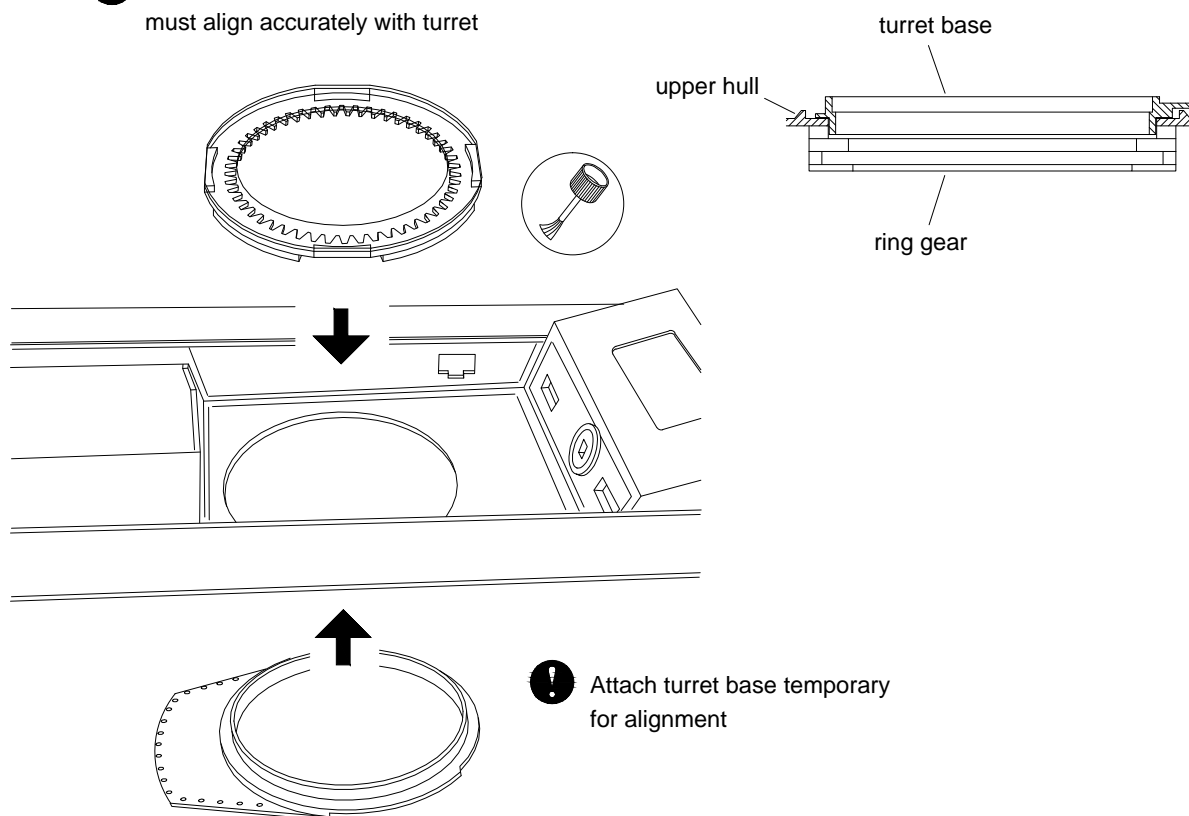

9 Speaker

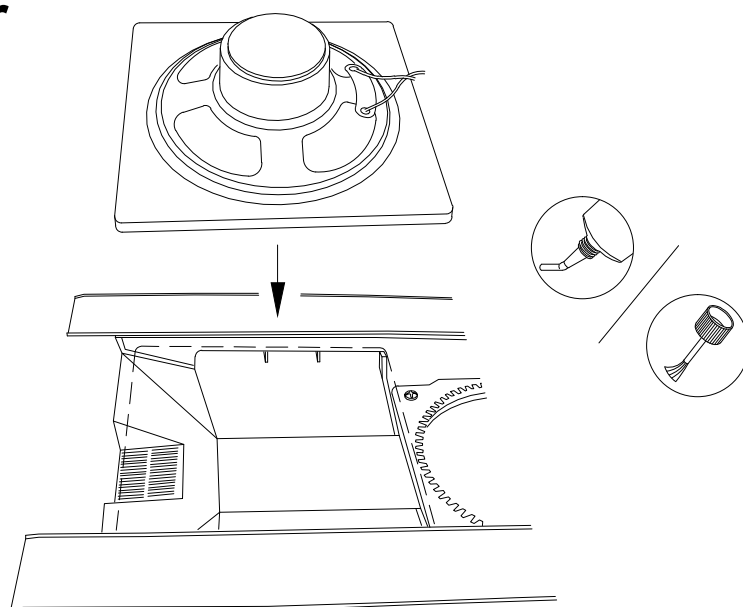

10 Connecting upper and lower hull

! To connect upper and lower hull, build edges as shown with 1mm PS plate. Chamfer edges for smooth insertion.

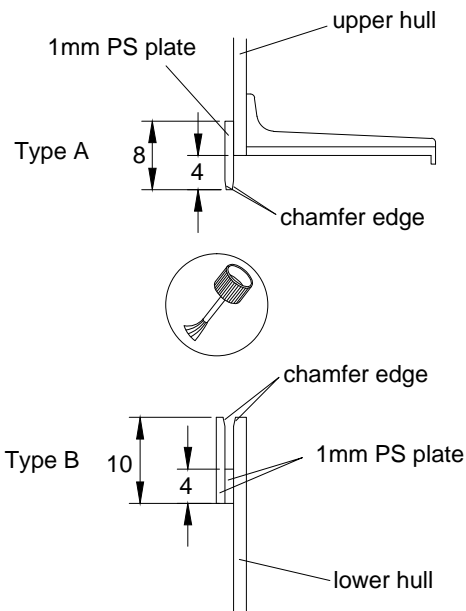
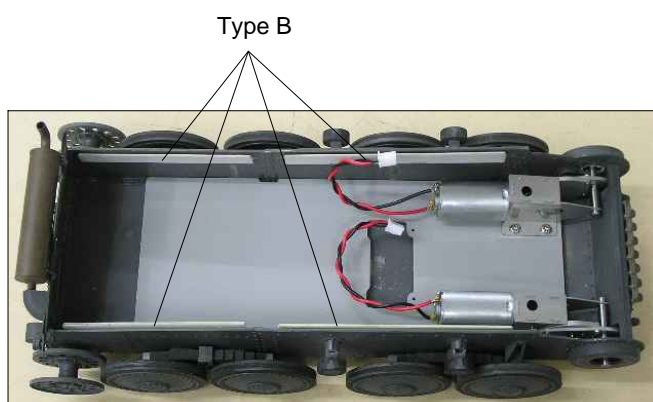
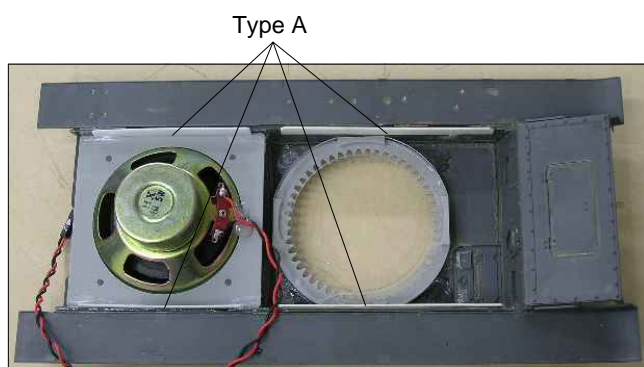

11 Machine gun

cut into two halves

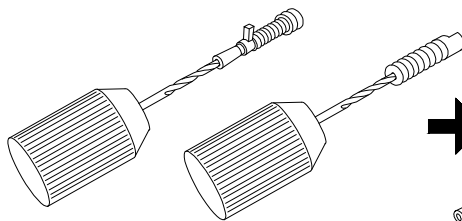
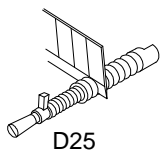

Drill $\varnothing 1\text{mm}$ holes from two ends

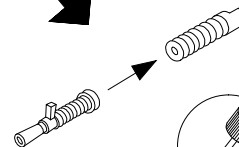
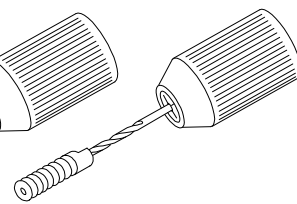

combine two halves

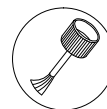

12 Turret

remove

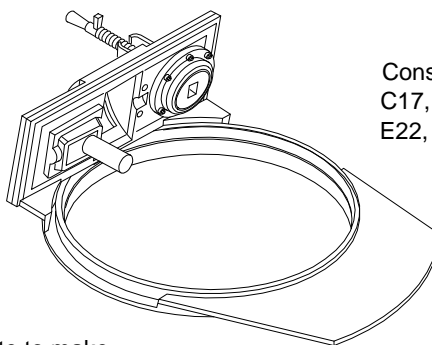
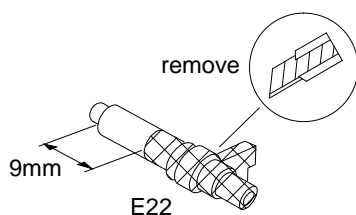

Construct turret including:
C17, B8, B6, F17, E12, D9,
E22, D25, F3, F4, F12, D18

Use 1mm PS plate to make
four pairs of snap catch.

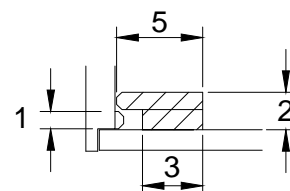
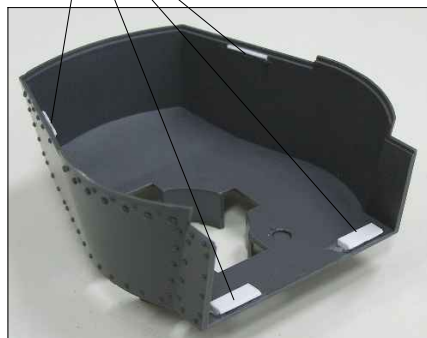

13 Main gun

D12

main gun assembly

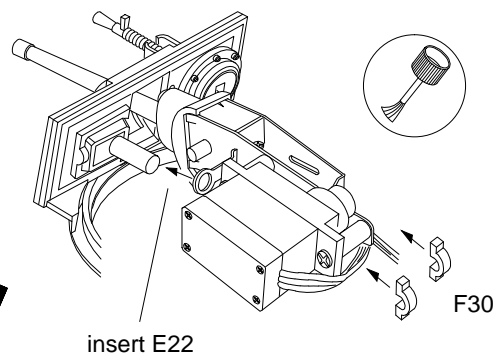
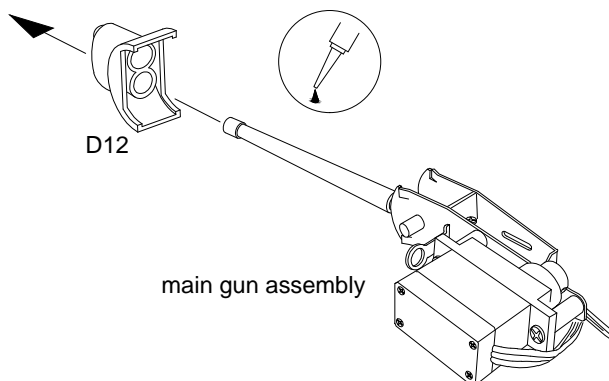

14 Turret servos and ACU



Attach turret servos assembly and ACU mount as shown.

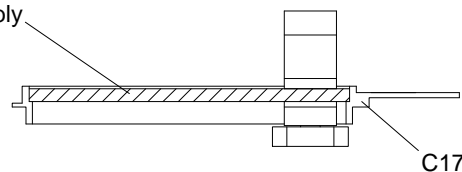

! keep cables away from moving parts, secure cables with adhesive tape

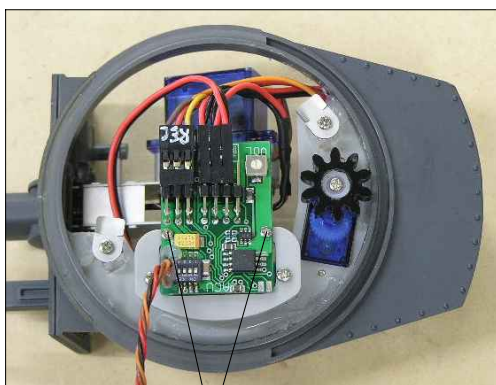

secure ACU with M1.7 x 4 screws

15 Attach turret

Rotate and secure the locking plate

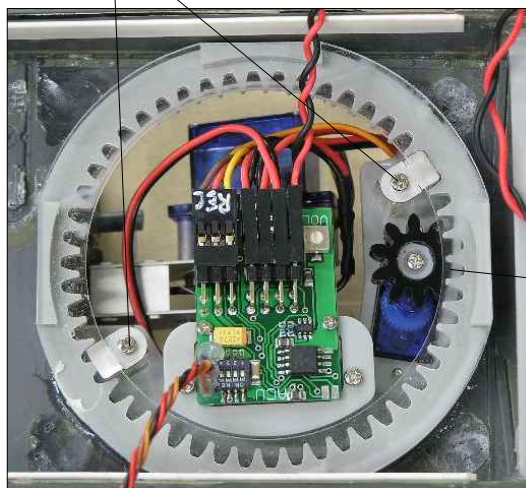

Engage pinion into ring gear

16 Using Lipo battery

❗ Lipo battery can be dangerous if not use properly! Follow all safety precautions and always use a dedicated Lipo charger.

- 1) Use 7.4V/2Cell Lipo battery (800-1500mAh)
- 2) Make sure battery is small enough to put inside the lower hull.
- 3) Solder connector for MTC-2 as shown. Keep original connector for charging.

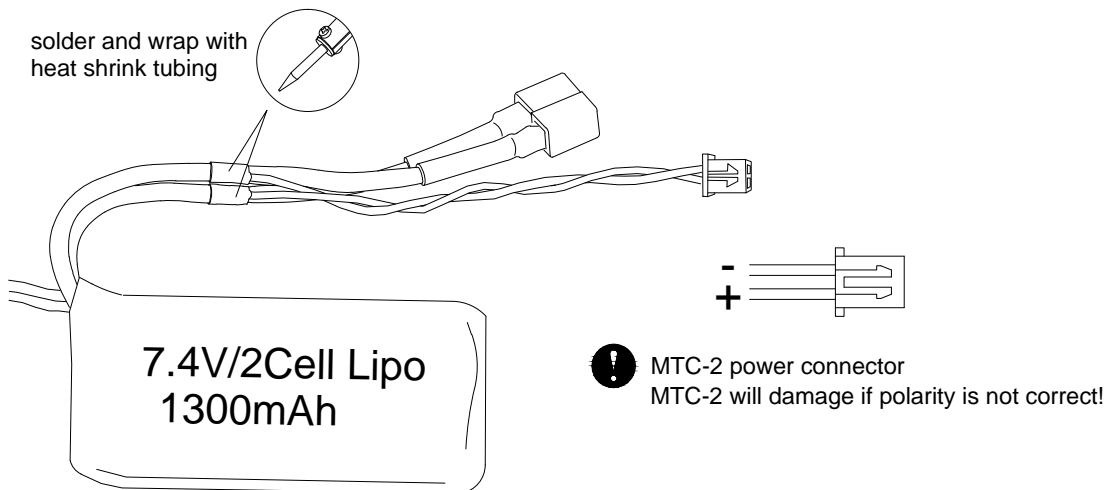

17 Lower hull connections

